

CORNER REPORT FORM

Section 2 Township 30S Range 3W
Douglas County Date 2-12

CORNER DESIGNATION

C-5 1/16

Condition Report only
Not Found
Renewed
Unrecorded
Surveyed In
Referenced out

Previous Renewals/Surveys, etc:

M 86-6 M 17-51

Monument(s) & Accessories Found: (Condition and Source)

Fd 5/8" BRASS ROD

Fd 12" D. FIR N59E 27⁶ FT GOOD SCAR

Monument Detail

Sketch

Fd 5/8" BRASS ROD

FILED

Date: 2/28/2012 By: JC

This survey consists of:

Map: _____

Reference: _____

Corner Rpt: CS 65/76-26

DOUGLAS COUNTY
SURVEYOR

Monument Set (Procedures and Description)

New Accessories

A 8" D. FIR N59E 8⁶ FT scribed C 5 1/16 S2 BT

Location & Comments

Surveyor's Seal

Compass Declination

Firm/Agency: i.e. Engineering, Inc.

Address: 809 S.E. Pine Street
Roseburg, OR 97470

Party Chief: Ron Quimby

Notes:

Witness:

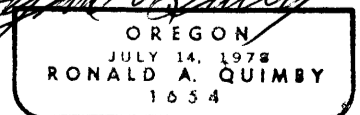
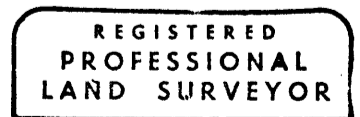

C.S. File No 65/76-26

EXP 12-31-12