

OREGON CORNER RESTORATION FORM

Section 24 Township 20 South, Range 8 West  
County Douglas Date 13 February 2012

FILED  
Date: 2/17/2012 By: JC  
This survey consists of:  
Map: \_\_\_\_\_  
Narrative: \_\_\_\_\_  
Corner Rpt: CS 65/76-17  
DOUGLAS COUNTY  
SURVEYOR

Corner Description

Section Corner  
Sections 23, 24, 25, 26

- Condition Report Only
- Not Found
- Renewed
- Unrecorded
- Surveyed In
- Referenced Out

Previous Renewals / Surveys, etc.

Monument (s) & Accessories Found: (Condition and Source)

Found BLM brass cap dated 1950 with the following accessories:  
70" Rotted R. Cedar stump bears N67-1/2°W 38.3'  
55" Rotted Hemlock stump bears S26°W 74.6'  
48" Rotted R. Cedar stump bears N15-1/2°E 49.5'  
37" Rotted Hemlock stump bears S36-1/2°W 33.7'

Monument Detail

Sketch

Monument Set (Procedures and Description)

None

New Accessories

18" D. Fir bears N32°W 25.4' – blazed, scribed "T20S R8W S23 BT"  
17" D. Fir bears S36°W 15.8' – blazed, scribed "T20S R8W S26 BT"  
14" D. Fir bears S55°E 9.3' – blazed, scribed "T20S R8W S25 BT"  
12" D. Fir bears N51°E 24.4' – blazed, scribed "T20S R8W S24 BT"

Location & Comments

Corner has steel post \_\_\_\_\_ Compass Declination 16° East  
adjacent to it. \_\_\_\_\_ Firm/Agency Ward NorthWest Inc.  
All BT's have red painted \_\_\_\_\_  
bands and yellow tags. \_\_\_\_\_ Address 1732 Laurel Pl. Ste. A  
\_\_\_\_\_ Florence, OR 97439  
\_\_\_\_\_ Party Chief Ron Rice  
\_\_\_\_\_ Notes \_\_\_\_\_  
\_\_\_\_\_ Witness Jason Collver

Surveyor's Seal

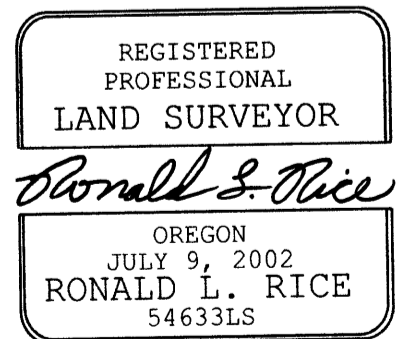

RENEWS: 12-31-2012

C.S. File No 65/76-17