

OREGON CORNER RESTORATION FORM

Section 28 Township 25 Range 5W
 County Douglas Date 1/26/12

FILED

Date: 2/14/2012 By: JC
 This survey consists of:
 Map: _____
 Narrative: _____
 Corner Rpt: CS 65/76-13

Corner Designation _____

T. 25 S. R. 5 W.

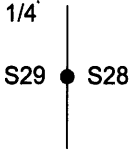

- _____ Condition Report Only
- _____ Not Found
- X _____ Renewed
- _____ Unrecorded
- _____ Surveyed In
- _____ Referenced Out

DOUGLAS COUNTY
SURVEYOR

Previous Renewals/Surveys, etc. Douglas County C.S. File 46/150, Douglas County
C.S. File 49/124, Holt Map M 56-65, Baker Map M 119-74, Hoffine Map M 132-44, Sweeden Subdivision V. 23 Pg. 25 A-C
 filed in the Douglas County Surveyor's Office.

Monument(s) & Accessories Found: (Condition and Source)

- Found 1955 Douglas County Brass Cap
- 19" Douglas-fir Bears N 75° W 19.4 Ft. (Record N 75° W 19.3 Ft.) Healed Face & Tag.
- 12" Rotted Douglas-fir Stump with iron spike Bears N 47 3/4° E 48.7 Ft. (Record N 48° E 48.8 Ft.) Rotted log with face & tag near stump.

Monument Detail

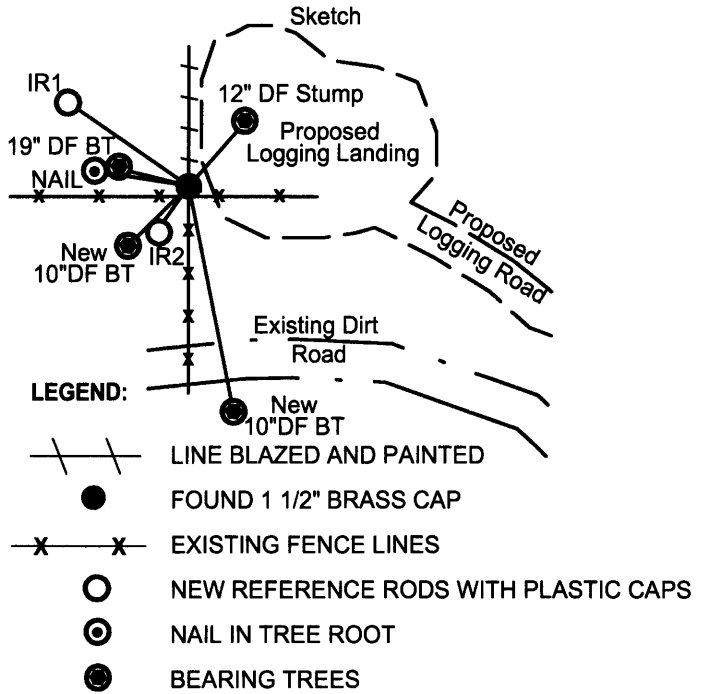
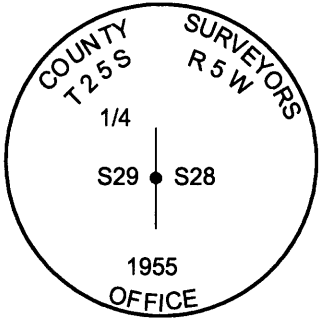

Monument Found

Found 1955 Douglas County Brass Cap

New Accessories

- 10" Douglas-fir Bears S 46 1/2° W 28.1 Ft. We Scribe 1/4 S29 B T & Tag.
- 10" Douglas-fir Bears S 11 1/2° E 137.9 Ft. We Scribe 1/4 S28 BT & Tag.
- IR 1 - 5/8"x30" Iron rod with yellow plastic cap marked Lone Rock Timber PLS 2291. Bears N 55°11'22" W 72.32 Ft.
- IR 2 - 5/8"x30" Iron rod with yellow plastic cap marked Lone Rock Timber PLS 2291. Bears S 34°44'07" W 25.57 Ft.
- Nail in tree root. Bears N 80°59'07" W 59.97 Ft.

Location & Comments

Corner is 0.8 ft. above ground level and approx. 1.5 ft. North of fence line. Corner lies on west edge of proposed logging landing. We place metal fence posts approx. 1.0 ft. North and East of corner. This corner may be disturbed by road building or logging operations. We made new BT's, set reference rods and nail as shown above to reset corner if it is disturbed.

Bearing Basis Assumed
 Firm/Agency Lone Rock Timber Co.
 Address P. O. Box 1127
Roseburg, Ore. 97470
 Party Chief Ken W. Hoffine
 Notes D. Saily
 Witness J. Roman

REGISTERED
PROFESSIONAL
LAND SURVEYOR

Ken W. Hoffine
 OREGON
 JULY 16, 1987
 KEN W. HOFFINE
 PLS 2291

EXPIRES 6/30/2013

C.S. File No 65/76-13