

MAP OF SURVEY

FILED

Date: 11/26/2012 By: NW

This survey consists of:

Map: C.S. 65/75-11

Narrative: _____

Corner Rpt: _____

LOCATED in Section 36, T. 21 S.
R. 7 W., W.M. in Douglas Co., Ore.

DOUGLAS COUNTY
SURVEYOR

November 21, 2012

SURVEYED FOR: *SENECA JONES TIMBER CO.*
P.O. BOX 10265
EUGENE, OREGON 97440

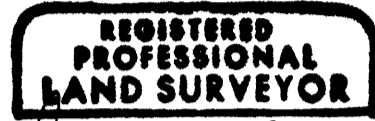

David A. Edwards



RENEWS 12/31/13

SURVEYED BY: *DAVID EDWARDS LAND SURVEYING*
P.O. BOX 361
OAKLAND, OREGON 97462
PHONE: (541) 459-0512

LEGEND

⊙ INDICATES B.L.M. OR COUNTY SURVEYOR BRASS CAP FOUND.

() DENOTES RECORD DATA PER B.L.M. RESURVEY.

SCALE: 1" = 1000'

————— INDICATES BOUNDARY BLAZED AND POSTED THIS SURVEY.

BASIS OF BEARINGS: B.L.M. RESURVEY AS SHOWN.

NARRATIVE

THE PURPOSE OF THIS SURVEY IS TO MARK THE EAST LINE OF THE SE 1/4 OF SECTION 36. A RANDOM TRAVERSE WAS RUN BETWEEN CONTROLLING CORNERS AND OFFSETS MADE TO TRUE LINE. THE LINE WAS MARKED BY BLAZING TREES ON EACH SIDE OF THE BOUNDARY, BY SETTING 6 FOOT STEEL POSTS ON LINE AT INTERVALS OF 200' OR LESS AND BY HANGING COPIOUS AMOUNTS OF RED FLAGGING ALONG THE TRUE LINE.

FIELD CREW: DAVID EDWARDS AND BRANT MILLER.

EQUIPMENT: NIKON TOTAL STATION.

COMPUTATIONS AND DRAFTING: DAVID EDWARDS.

