

RECORD OF SURVEY

FILED

LOCATED IN THE SW 1/4 OF
SECTION 10, T.29S., R.9W., W.M.
DOUGLAS COUNTY, OREGON

Date: 6-19-2012 By: JC
This survey consists of:
Map: CS 65/75-7
Narrative: _____
Corner Rpt: _____

1968 USBLM BCIP &
ASSESSORIES PER
PLSS ID. NO. 400540

**DOUGLAS COUNTY
SURVEYOR**

NARRATIVE:

THE PURPOSE OF THIS SURVEY IS POST AND BLAZE THAT LINE BETWEEN THE 1/4 CORNER OF SECTIONS 9 & 10 AND THE SOUTH SECTION CORNER OF SECTIONS 9 & 10, T29S, R9W., W.M. AS SHOWN ON THE FACE OF THIS MAP. THIS SURVEY WAS CONTROLLED BY MONUMENTS FOUND PER A USBLM DEPENDANT RESURVEY BY PETERSON IN 1968.

THIS SURVEY WAS PERFORMED BY LESTER FANNING AND SCOTT MCCURDY USING A LEICA 1200 SYSTEMS TOTAL STATION WITH COMPUTATIONS AND DRAFTING BY KRIS DEGROOT AND SCOTT MCCURDY.

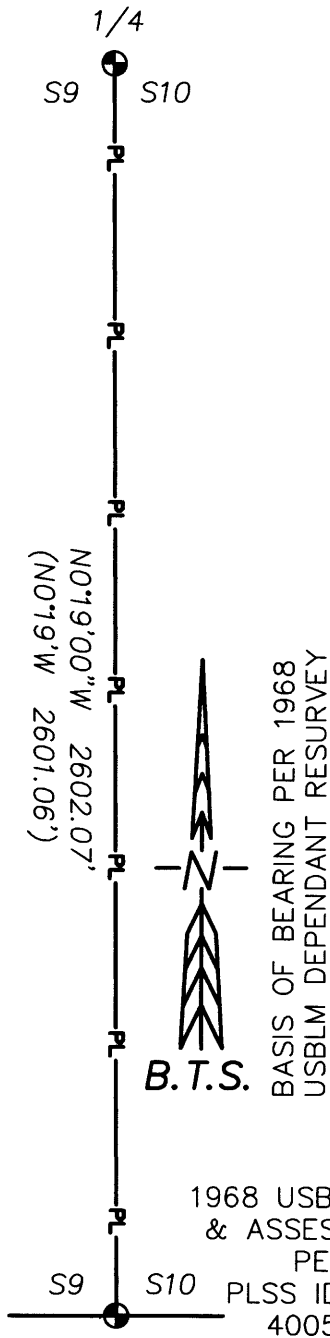

REGISTERED
PROFESSIONAL
LAND SURVEYOR

Kristian O. Degroot

OREGON
JULY 17, 1981
KRISTIAN O. DEGROOT
1941

RENEWAL DATE: 12-31-2011

LEGEND:

- ⊕ = FOUND BRASS CAP AS NOTED
- () = RECORD PER 1968 USBLM DEPENDANT RESURVEY
- PL— = PROPERTY LINES BLAZED, PAINTED & POSTED WITH 5 1/2' STEEL POSTS.

BTS

ENGINEERING & SURVEYING, INC.

431 S.E. MAIN ST., ROSEBURG, OR 97470
PHONE (541) 673-0966 FAX (541) 673-0105

SCALE: 1" = 400'

DATE: NOV 18, 2011

FOR:
SILVER BUTTE TIMBER CO.
P.O. BOX 4
RIDDLE, OR 97469

JOB #: 11-062

FILE: 11-062 SBTC.DWG

SHEET 1 OF 1

C.S. File No 65/75-7