

MAP OF SURVEY

FILED

Date: 5/22/2012 By: JE
This survey consists of:
Map: C.S. 65/75-6
Name: _____
Corner: _____

LOCATED in the NW 1/4 of
Section 12, T.27S., R.2W., W.M.
in Douglas County, Oregon.

DOUGLAS COUNTY
SURVEYOR

May 18, 2012

SURVEYED FOR: *SENECA JONES TIMBER CO.*
P.O. BOX 2129
ROSEBURG, OREGON 97470

REGISTERED
PROFESSIONAL
LAND SURVEYOR

David A. Edwards

SURVEYED BY: *DAVID EDWARDS LAND SURVEYING*
P.O. BOX 361
OAKLAND, OREGON 97462
PHONE: (541) 459-0512

OREGON
JULY 26, 1908
DAVID A. EDWARDS
2339
RENEWS 12/31/13

LEGEND

- ⊙ INDICATES BRASS CAP FOUND AT THE CENTER 1/4 CORNER OF SECTION 12 PER C.S. 62/33.
- INDICATES 2" DIAM. IRON PIPE FOUND AT THE INITIAL POINT OF "FOREST HAVEN 1ST ADDITION".
- () DENOTES RECORD DATA PER PLAT OF FOREST HAVEN 1ST ADDITION.

SCALE: 1" = 600'

BASIS OF BEARINGS: PLAT OF FOREST HAVEN 1ST ADDITION.

NARRATIVE

THE PURPOSE OF THIS SURVEY IS TO MARK THE BOUNDARY SHOWN HEREON. THIS WAS ACCOMPLISHED BY BLAZING TREES ON EACH SIDE OF LINE, BY SETTING 6 FOOT STEEL POSTS ON LINE AT INTERVALS OF 200 FEET OR LESS AND BY HANGING LIBERAL AMOUNTS OF RED FLAGGING ALONG THE TRUE LINE.

FIELD CREW: DAVID EDWARDS AND BRANT MILLER.

EQUIPMENT: NIKON TOTAL STATION.

COMPUTATIONS AND DRAFTING: DAVID EDWARDS.

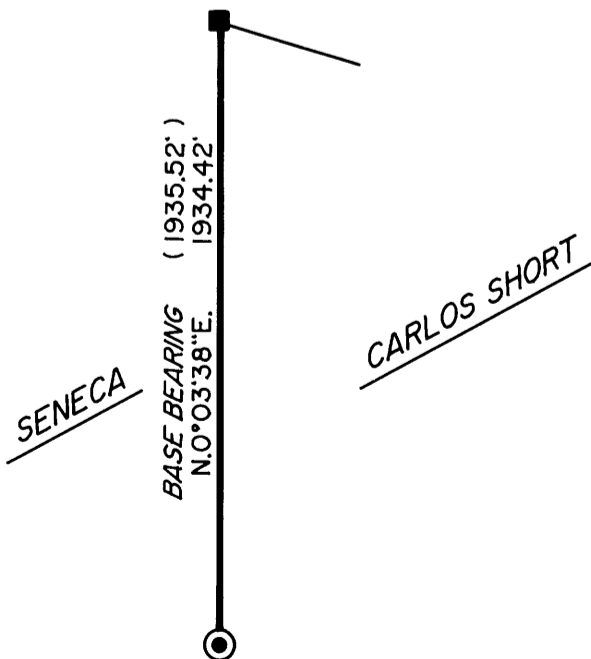

C.S. File No 65/75-6