

FILED

Date: 3/21/2011 By: SC
This survey consists of:

CORNER REPORT FORM

Section 18 Township 31 Range 7
Douglas County Date 3-11

Map: _____
Narrative: _____
Corner Rpt: CS 65/72-8

CORNER DESIGNATION

100 500

Condition: DOUGLAS COUNTY
Not Found SURVEYED
Renewed
Unrecorded
Surveyed In
Referenced out

Previous Renewals/Surveys, etc:

Lecklider 6/62
DCSO 10/66

Monument(s) & Accessories Found: (Condition and Source)

DCSO BRASS CAP GOOD CONDITION
36" PINE STUMP N31W 55.4 FT
30" PINE S16°E 105.6 FT GOOD SCAR
30" PINE S68°W 88.4 FT GOOD SCAR
20" FIR N44°W 25.6 FT GOOD SCAR
24" PINE S7W 19.9 FT GOOD SCAR
20" PINE S37E 20.1 FT GOOD SCAR
16" D FIR N21E 33.2 FT GOOD SCAR

Monument Detail

Sketch

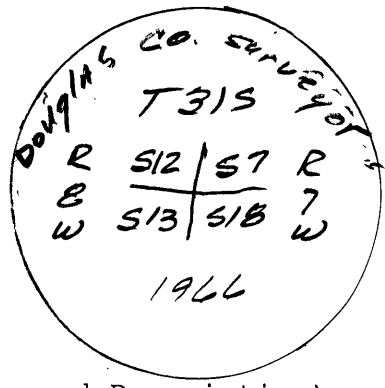

Monument Set (Procedures and Description)

New Accessories

Location & Comments

CORNER IS IN
FLAT AREA APPROX
150' N.E. OF ROAD

Compass Declination

Firm/Agency: i.e. Engineering, Inc.

Address: 505 SE Main
Roseburg, OR 97470

Party Chief: Palmer

Notes:

Witness:

Surveyor's Seal

REGISTERED
PROFESSIONAL
LAND SURVEYOR

Ronald A. Quimby
OREGON
JULY 14, 1978
RONALD A. QUIMBY
1654

EXP 12-31-12
C.S. File No 65/72-8