

FILED

Date: 12-14-2010 By: JC
This survey consists of:
Map: _____
Narrative: _____
Corner Rpt: CS 65/69-63
DOUGLAS COUNTY
SURVEYOR

DOUGLAS COUNTY CORNER RESTORATION FORM

SECTION 20 TOWNSHIP 20S RANGE 6W W.M. BLM ID# 200300
DLC _____ CORNER SOUTHWEST
DATE 9/08/2010 CONDITION REPORT RENEWED

CORNER RESTORATION FIELD BOOK _____ PAGE _____

PREVIOUS RENEWALS/SURVEYS, ETC.:

SEE LANE COUNTY AND DOUGLAS COUNTY RECORDS

MONUMENT (S) AND ACCESSORIES FOUND, CONDITION AND (ORIGIN)

- 3 1/4" BRASS CAP, ON A 2 1/2" IRON PIPE, UP 4" (B.L.M. 1972)
FOUND A METAL U POST 0.4' NW AND A THIN WALLED IRON PIPE 5.6' NE.
- 27"D. fir, with a healed face and B.L.M. B.T. tag, bears N57°E, 21.6' (21.6 Baker visitation 1999) (33 links) (B.L.M. 1972)
- 46"D. fir snag, 20'± tall, with a B.L.M. B.T. tag, and a healed face, also a cruisers mark bears S47°E 41.4' (41.4' Baker visitation 1999) (61 links B.L.M.) (Hinkson, Lane County RE 850)
- 14"D. fir stump, 4' tall, sniped, with a healed face and B.L.M. B.T. tag bears S19°W 25.1' (B.L.M. 1972)
- 37"D. fir with a healed face and B.L.M. B.T. tag, and a cruisers mark, bears N41°W 30.7' (45 links - B.L.M. notes, 41 links on B.L.M. B.T. tag) (30.7' Baker visitation 1999) (Hinkson, Lane County RE 850)

MONUMENT (S) SET (PROCEDURES AND DESCRIPTION)

NONE

NEW ACCESSORIES:

8" D. fir, bears S42°E, 20.3', scribed "T20SR6WS29BT" a R.R.C. B.T. tag was attached.

COMMENTS:

ALL FACES WERE PAINTED RED, AS WAS A 6" BAND AROUND THE TREES AND STUMP. THE TOP OF THE STUMP WAS ALSO PAINTED RED.

DISTANCES TO THE ACCESSORIES WERE MEASURED WITH A 75' BUCKERS TAPE OR A TOTAL STATION TO THE SIDE CENTER.

BEARINGS WERE OBTAINED OR COMPARED TO THOSE OF RECORD USING A HAND COMPASS WITH THE DECLINATION SET AT 16°E.

MONUMENT DETAIL:

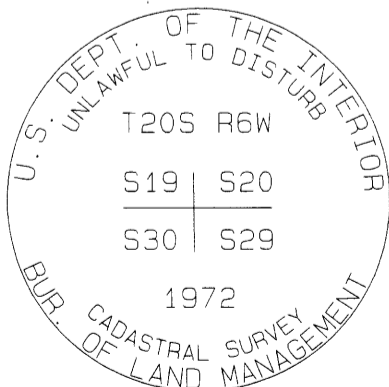

INMAN SURVEYING, LLC
1325 AUDEL AVENUE
EUGENE, OR 97404
(541) 607-9559

REGISTERED
PROFESSIONAL
LAND SURVEYOR

OREGON
JULY 13, 2004
KENT RYAN INMAN
60050LS

Expiration Date: 6/30/2011

SKETCH:

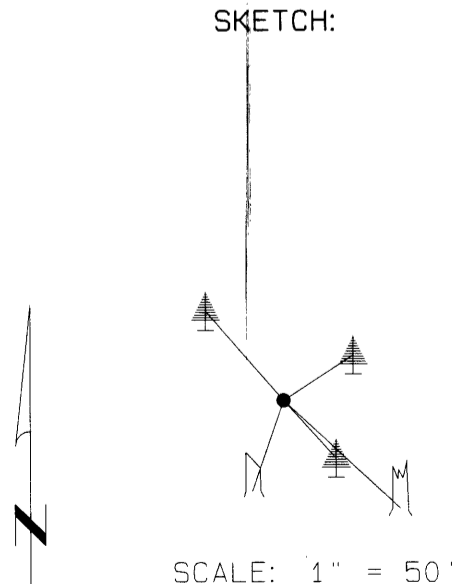

C.S. File No 65/69-63