

FILED

Date: 7/7/2010 By: JC

This survey consists of:

Map: _____

Narrative: _____

Corner Rpt: CS 65/69-38

CORNER REPORT FORM

Section 6 Township 24 South Range 6 West
Douglas County Date: 6/28/2010

Corner Designation

- Condition Report Only
- Not Found
- Renewed
- Unrecorded
- Surveyed In
- Referenced Out

DOUGLAS COUNTY
SURVEYOR

Previous Renewals/Surveys, etc. See T 24 S, R 6 W, Card 200600

Monument (s) & Accessories Found: (Condition and Source)

- 44" D. Fir bears N14°E, 44.9' (healed face)
- 22" Madrone bears N10°W, 12.0' (healed face)
- 26" single of a 50" double Madrone bears S80°E, 19.5'
- 13" Chinquapin snag bears S86°W, 7.3'
- 15" D. Fir bears S62°W, 28.0' (healed face)

Monument Detail

Sketch

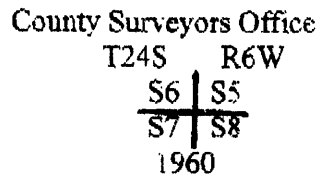

Monument Set (Procedures and Description)

New Accessories

Location & Comments

Compass Declination:
 Firm/Agency: Ward NorthWest Inc.
 Address: P.O. Box 105, Florence, OR 97439
 Party Chief: Ron Rice
 Notes:
 Witness: Josh Reed

Surveyor's Seal

REGISTERED
PROFESSIONAL
LAND SURVEYOR

Robert B. Ward Jr.

OREGON
ROBERT B. WARD JR.
JULY 20 1976
1001

Renew 6/30/12

C.S. FILE NO 65/69-38