

FILED

Date: 6/11/2009 By: JC

This survey consists of:

For Map: 2009-0027

Narrative:

Genl Rpt: CS 65/68-4

AFFIDAVIT OF CORRECTION (Plat)

DOUGLAS COUNTY SURVEYOR

I, Ronald A. Quimby, being duly sworn, depose and say that I am the surveyor who surveyed Partition Plat #2009-27, as filed and recorded in Douglas County, Oregon Plat Records; and

The following correction to said plat is necessary and is as follows:

1. Distance on North line of Parcel 3 changes from 528.17' to 527.12'.
2. Distance on East line of Parcel 3 changes from 190.79' to 191.35'.
3. Distance on East boundary between North line of Parcel 3 and North boundary line changes from 236.26' to 235.70'.

The present fee owner of the property materially affected by said Affidavit is as follows:

1. Kenneth E. & Joanne Debell

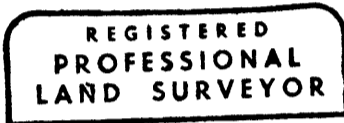

*Ronald A. Quimby*

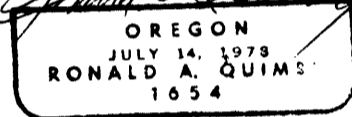

*Ronald A. Quimby*

Ronald A. Quimby  
Registered Professional Land Surveyor #1654

STATE OF OREGON )  
)ss  
COUNTY OF DOUGLAS)

Subscribed and sworn before me on this 9<sup>th</sup> day of June, 2009.

*Elaine Berg*

Notary Public for Oregon  
My Commission Expires: June 23, 2010

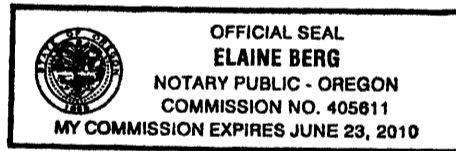

I, ROMNEY WARE, Douglas County Surveyor, do hereby certify that said Affidavit of Correction for Partition Plat #2009-27, has been examined by me and that it complies with ORS 92.170.

*Romey Ware*  
\_\_\_\_\_  
, County Surveyor

6-9-09

DOUGLAS COUNTY OFFICIAL RECORDS  
BARBARA E. NIELSEN, COUNTY CLERK

2009-010770



NO FEE

00247190200900107700010014

06/11/2009 09:09:13 AM

PLAT-CORR Cnt=1 Stn=3 MARRIAGECOUNTER  
This is a no fee document

END OF DOCUMENT

C.S. File No 65/68-4