

CORNER RENEWAL SURVEY FOR LONE ROCK TIMBERLAND CO.

SECTION 18 T. 23 S. R. 6 W., W. M.
DOUGLAS COUNTY, OREGON
SURVEYED BY: LONE ROCK TIMBER MANAGEMENT CO.
P. O. BOX 1127 ROSEBURG, OREGON 97470
OCTOBER 2009

NARRATIVE:

THIS SURVEY WAS CONDUCTED TO ESTABLISH PROPERTY LINES FOR TIMBER CUTTING PURPOSES. TOWNSHIP 23 SOUTH RANGE 6 WEST WAS INITIALLY RESURVEYED BY THE GLO IN THE 1940'S WITH FEW ORIGINAL CORNERS FOUND FROM THE ORIGINAL 1883 SURVEY. WILFORD HAINES PLS #239 AND LEO MARTIN #363, IN A 1956 SURVEY LOCATED NUMEROUS ORIGINAL MONUMENTS IN THE NORTHWEST CORNER OF THE TOWNSHIP THAT THE BLM DID NOT LOCATE DURING THEIR SURVEY (MUCH TO THE CHAGRIN OF THE BLM SURVEYORS). THE BLM WAS FORCED INTO ANOTHER RESURVEY OF MUCH OF THE TOWNSHIP WHICH THEY DID INDEPENDENT OF HAINES IN 1957 AND SET BLM PROPORTIONED MONUMENTS WITH NO MENTION OF NEARBY HAINES CORNER MONUMENTS. WE INITIATED OUR SURVEY AT THE SOUTH 1/4 OF SECTION 18, A BLM 1957 BCIP SET BY PROPORTION BETWEEN ORIGINAL CORNER LOCATIONS AT THE SOUTHEAST AND SOUTHWEST CORNERS OF SECTION 18. HAINES SOUTH 1/4 MONUMENT IS MISSING, BUT BOTH OF HIS BEARING TREES ARE ROTTEN STUMPS. HAINES SOUTH 1/4 POSITION FROM THE BEARING TREES IS N25 1/2°E, 19.79 FEET FROM THE BLM MONUMENT. WE RAN A CLOSED LOOP RANDOM TRAVERSE ALONG A SINGLE LINE TO THE NORTH 1/4 OF SECTION 18, A BLM 1957 BCIP FROM WHICH HAINES 1956 T-BAR BEARS S20°W, 21.67 FEET. THE NORTH 1/4 MONUMENTS SET BY THE BLM AND HAINES WERE SET BY PROPORTION BETWEEN AN ORIGINAL CORNER POSITION AT THE NW CORNER OF SECTION 18 AND A DOUBLE PROPORTIONED CORNER AT THE NE CORNER OF SECTION 18. WE ALSO FOUND HAINES CENTER 1/4 WHICH DUE TO THE CIRCUMSTANCES OF HAINES NORTH 1/4 BEARS WEST OF THE BLM NORTH 1/4 AND HAINES SOUTH 1/4 BEARS EAST OF THE BLM SOUTH 1/4, WE FIND HAINES CENTER 1/4 POSITION IS WITHIN 0.2 FEET OF LINE BETWEEN THE BLM NORTH AND SOUTH 1/4 MONUMENTS. WE SET REFERENCE IRON RODS ON THE NORTH-SOUTH CENTERLINE BETWEEN THE BLM CORNERS AT 106.67 FEET SOUTHERLY AND 120.58 FEET NORTHERLY FROM HAINES CENTER 1/4 MONUMENT. WE ALSO BLAZED, PAINTED, TAGGED AND RIBBONED THE CENTERLINE OF SECTION 18 BETWEEN THE BLM MONUMENTS. THIS SURVEY WAS DONE WITH A NIKON DTM 522 TOTAL STATION WITH GARY ANGIOLET AND IGNACIO ROMAN ASSISTING ME.



- 1) THE QUARTER CORNER BETWEEN SECTIONS 7 AND 18
FOUND 1957 BLM CAP.
-- HAINES T-IRON BEARS S20°14' W, 21.67 FEET
-- 32" DOUGLAS FIR BEARS N8°W, 14.5 FEET (RECORD N8°W, 14.52 FEET) HEALED FACE AND TAG
-- 24" DOUGLAS FIR BEARS S36°E, 60.5 FEET (RECORD S35°E, 59.40 FEET) HEALED FACE AND TAG
-- 31" DOUGLAS FIR BEARS S56 1/2°W 7.2 FEET BARK SCRIBED THIS IS A BT FOR HAINES T-IRON
BLM BCIP LIES ON STEEP SPUR RIDGE.
- 2) HAINES CENTER QUARTER FOR SECTION 18
FOUND HAINES T-IRON
-- 28" DOUGLAS FIR BEARS N11 1/4° E, 12.1 FEET AND (RECORD N15°E 12.2FEET) HEALED FACE AND LRT TAG
-- 23" DOUGLAS FIR BEARS S67 1/4°W, 26.1 FEET (RECORD S65°W, 26.3 FEET) HEALED FACE AND LRT TAG
-- 20" DOUGLAS FIR BEARS S16 3/4°E, 18.6 FEET NO RECORD HEALED FACE AND LRT TAG
-- SET 5/8" X40" IRON ROD WITH YELLOW PLASTIC CAP BEARS S12° 54'E 106.67 FEET
-- SET 5/8" X 40" IRON ROD WITH YELLOW PLASTIC CAP BEARS N13° 08'W 120.58 FEET
HAINES T-IRON LIES IN SLUMP AREA AT HEAD OF APPROX. 30 FOOT WIDE SHALLOW DRAW.
- 3) THE QUARTER CORNER BETWEEN SECTIONS 18 AND 19
FOUND 1957 BLM CAP.
-- 12" DOUGLAS FIR BEARS N46°E 6.2 FEET (RECORD S44 1/2°E 6.2 FEET) HEALED FACE AND TAG
-- 10" DOUGLAS FIR AT RECORD OF N34°W 6.8 FEET IS DOWN AND UPROOTED.
-- NEW 10" DOUGLAS FIR B.T.BEAR S44 1/2°W 24.2 FEET WE SCRIBE 1/4 S19 BT AND TAG.
-- NEW 16" DOUGLAS FIR B.T.BEAR N76 1/4°E 20.8 FEET WE SCRIBE 1/4 S18 BT AND TAG.
-- POINT FOR HAINES QUARTER CORNER BEARS N25° 33'E 19.79 FEET COULD NOT FIND T - IRON COMPUTED FROM BEARING AND DISTANCE OF HAINES BT'S.
-- 22" DOUGLAS FIR STUMP BEARS S33°E 11.5 FEET TO HAINES CORNER LOCATION
-- ROTTEN STUMP REMAINS BEARS N62°W 34.6 TO HAINES CORNER LOCATION
BLM BCIP LIES ON 40% NORTH FACING SLOPE APPROX. 70 FEET NORTH OF TOP OF FLAT SPUR RIDGE IN HEAVY REPROD.

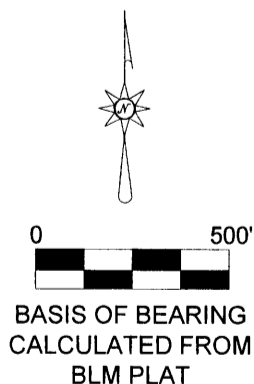

REGISTERED
PROFESSIONAL
LAND SURVEYOR

Ken W. Hoffine

OREGON
JULY 16, 1987
KEN W. HOFFINE
PLS 2291

EXPIRES 6-30-11

LEGEND:

- +++ LINES, BLAZED, PAINTED, & TAGGED
- △ 1957 GLO BRASS CAP
- 1957 HAINES T-IRON