

OREGON CORNER RESTORATION FORM

Section 22 Township 26 S Range 3 W
 County Douglas Date 9/2/09

FILED
 Date: 9/15/2009 By: X
 This survey consists of:
 Map: _____
 Narrative: _____
 Corner Rpt: CS 65/66-39

Corner Designation

T. 26 S. R. 3 W.

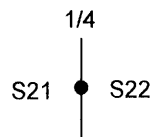

- _____ Condition Report Only
- _____ Not Found
- X _____ Renewed
- _____ Unrecorded
- _____ Surveyed In
- _____ Referenced Out

**DOUGLAS COUNTY
 SURVEYOR**

Previous Renewals/Surveys, etc.

1964 BLM plat, 1978 BLM plat

Monument(s) & Accessories Found: (Condition and Source)

20" Tall Stump Bears S72 1/2°E 20.9 ft. (record S72°E 21.12 ft.) healed face and tag.

24" Douglas Fir Bears S25°W 400.32 ft. per record did not measure healed face and tag.

104.94

Monument Detail

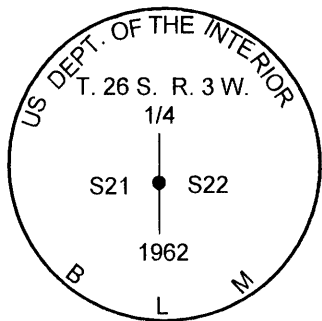

LEGEND:

- LINE BLAZED AND PAINTED
- 1962 COUNTY CAP
- BLM 1962 Resurvey

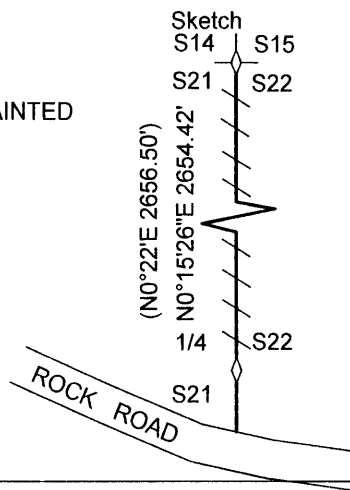

Monument Found

BLM BCIP 0.3 feet above ground.

New Accessories

22" Douglas fir bears S43 1/4°E 22.1 ft. we scribe 1/4 S22 BT and tag.

16" Douglas fir bears N41 1/2°E 37.5 ft. we scribe 1/4 S21 BT and tag.

Location & Comments

Corner lies on north slope
approx. 150 feet north of
BLM rock road. Merchantable
timber to east. 30 foot tall
reprod to west.

Compass Bearing Basis of bearing from GPS
 Firm/Agency Lone Rock Timber Co.
 Address P. O. Box 1127
Roseburg, Ore. 97470
 Party Chief Ken W. Hoffine
 Notes Gary Angiolet
 Witness Iginaco Roman

REGISTERED
**PROFESSIONAL
 LAND SURVEYOR**

Ken W. Hoffine
 OREGON
 JULY 16, 1987
KEN W. HOFFINE
 PLS 2291

EXPIRES 6-30-11

C.S. File No 65/66-39