

FILED

Date: 1-23-2008 By: JC

This survey consists of:

Map: \_\_\_\_\_

Narrative: \_\_\_\_\_

Corner Rpt: 65/63-6

CORNER REPORT FORM

Section 15 Township 29S Range 8W

Douglas County Date 12/2007

CORNER DESIGNATION

460400

DOUGLAS COUNTY

Condition Report only

Not Found

Renewed

Unrecorded

Surveyed In

Referenced out

Previous Renewals/Surveys, etc:

BLM 1976

Monument(s) & Accessories Found: (Condition and Source)

Fd BLM BRASS CAP

9" W. FIR N77°E 33' FT (HEALED FACE)

17" FIR S66°E 26' FT (HEALED FACE)

Monument Detail

Sketch

BLM BRASS CAP

E 1/16     515  
                  522  
                  1976

Monument Set (Procedures and Description)

New Accessories

Location & Comments

Surveyor's Seal

Compass Declination

Firm/Agency: i.e. Engineering, Inc.

Address: 505 SE Main  
Roseburg, OR 97470

Party Chief: M. Frommholz

Notes:

Witness:

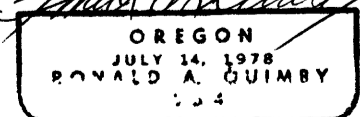
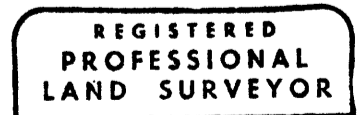

C.S. File No 65/63-6 EXP 12-31-08