

FILED

Date: 1-23-08 By: JC

This survey consists of:

Map: _____

Narrative: _____

Corner Rpt: 65/63-5

CORNER REPORT FORM

Section 23 Township 29S Range 8W

Douglas County Date 1/2008

CORNER DESIGNATION

500400

15/14
22/23

DOUGLAS COUNTY
Condition Report only
Not Found
Renewed
Unrecorded
Surveyed In
Referenced out

Previous Renewals/Surveys, etc:

BLM 1975 Douglas County Surveyor's Office

Monument(s) & Accessories Found: (Condition and Source)

FD 1975 BLM BRASS CAP
FD 16" FIR N72 1/2 E 30.1 FT
12" FIR S50 3/4 E 13.9 FT
16" W. FIR S50 W 17.8 FT
21" W. FIR N81 1/2 W 18 1/2 FT

Monument Detail

Sketch

Monument Set (Procedures and Description)

None

New Accessories

None

Location & Comments

Surveyor's Seal

Compass Declination

Firm/Agency: i.e. Engineering, Inc.

Address: 505 SE Main
Roseburg, OR 97470

Party Chief: M. Fromdahl

Notes:

Witness:

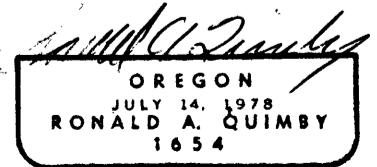
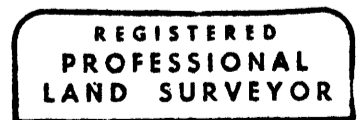

C.S. File No 65/63-5

EXP 12-31-08