

OREGON CORNER RESTORATION FORM

Section 26 Township 22 S. Range 7 W.
 County Douglas Date 12/5/07

FILED

Date: 12/10/2007 By: JC
 This survey consists of:
 Map: _____
 Narrative: _____
 Corner Rpt: 65/60-55

Corner Designation _____

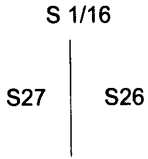

- Condition Report Only
- Not Found
- Renewed
- Unrecorded
- Surveyed In
- Referenced Out

DOUGLAS COUNTY
SURVEYOR

Previous Renewals/Surveys, etc.
HAINES 1957 MAP M 1 -59

Monument(s) & Accessories Found: (Condition and Source)

34" DOUGLAS FIR STUMP BEARS N87 1/4°E 10.8 FEET (RECORD 26" FIR N87°E 10.9 FEET) HEALED FACE AND TAG

Monument Detail

HAINES T - IRON

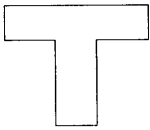

Sketch

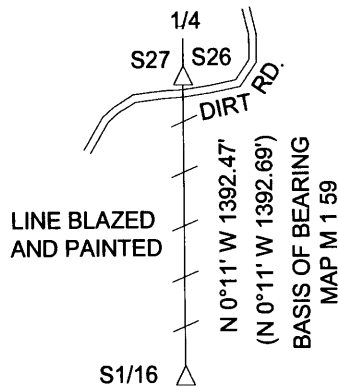

Monument Set (Procedures and Description)

New Accessories

18" DOUGLAS FIR BEARS N8 3/4°W 68.9 FEET WE SCRIBE S1/16 S27 BT AND TAG

11" DOUGLAS FIR BEARS S50 1/4°E 19.2 FEET WE SCRIBE S1/16 S26 BT AND TAG

Location & Comments

CORNER LIES ON SOUTH
FACING SLOPE AND
APPROX. 150 FEET NORTH
OF SMALL CREEK

Compass Bearing _____
 Firm/Agency Lone Rock Timber Co.
 Address P. O. Box 1127
Roseburg, Ore. 97470
 Party Chief KEN W. HOFFINE
 Notes GARY ANGIOLET
 Witness IGNACIO ROMAN

REGISTERED
PROFESSIONAL
LAND SURVEYOR

Ken W. Hoffine
 OREGON
 JULY 16, 1987
 KEN W. HOFFINE
 PLS 2291

EXPIRES 6-30-09

C.S. File No 65/60-55