

FILED

Date: 11/15/2007 By: JC

This survey consists of:

Map: _____

Narrative: _____

Corner Rpt: 65/60-51

DOUGLAS COUNTY
SURVEYOR

CERTIFIED RECORD OF LAND CORNER MONUMENTATION

History of original corner establishment: Center 1/4 corner of section 8, T. 32 S., R. 3 W., W. M.
G-7 260540

Malcolm N. Clark, L.S. 601, established the corner in 1980 for the subdivision of section 8 (Douglas County M83-55/CS file 58/277-4). He set a 2-1/2"x30" aluminum pipe with a 2-1/2" aluminum cap, marked as shown. Clark established new bearing trees: a 6" Douglas Fir, S. 77° 10' E., 39.7 ft., marked "T32S R3W C1/4 BT"; and a 5" Douglas Fir, N. 16° 35' W., 26.6 ft., marked "T32S R3W C1/4 BT". A 3/4" brass washer, marked "RLS 601", is attached to lower blaze of each new BT.

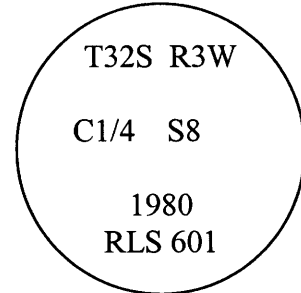

Gerald V. Nygren, L.S. 1035, perpetuated the corner in 1988 (CS file 63/69-27). Nygren found the aluminum cap stamp as shown. He found Clark's bearing trees: a 6" D. Fir stob, S. 77° 10' E., 39.7 feet, with visible scribes; and a 7" D. Fir, N. 16° 35' W., 26.6 feet, with healed blaze. Nygren marked a new bearing tree: an 8" madrone, N. 72° W., 14.9 feet, bark scribed "C1/4 S8 BT" and a 1/2" brass washer is attached to lower end of scribing.

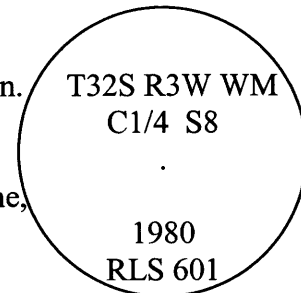

Description of corner evidence found: November 13, 2007

I found a 2-1/2 inch outside diameter aluminum pipe, firmly set, projecting 6 inches above ground, with a 2-1/2 inch diameter brass cap attached, marked as above.

From which the following bearing trees marked by Clark in 1980:

- a 6" Douglas fir stob, bears S. 77-1/4° E., 39.7 feet, (rec. S. 77° 10' E.) with illegible scribe marks on a partially healed blaze.
- a 10" Douglas fir, bears N. 11-1/2° W., 27.9 feet, (rec. N. 16° 35' W., 26.6 feet) with healed double blaze.

And a bearing tree established by Nygren in 1988:

- an 8" madrone, bears N. 67-3/4° W., 14.9 feet, (rec. N. 72° W.) with scribe marks "C1/4 S8" "BT" visible on double bark blaze.

Description of monument and accessories I established to perpetuate the original location of this corner: None.

With a staff compass I sighted on the posted North-South centerline, which has a platted bearing of N. 0° 11' 12" E. as my basis of bearings. I determined the magnetic declination to be 16-1/4° East. Trees are measured to the center of the root crown. Tree diameters are at breast height.

My certificate expires June 30, 2009

Leonard E. Herzstein, L.S. 2150
Umpqua National Forest
2900 NW Stewart Parkway
Roseburg, OR 97470

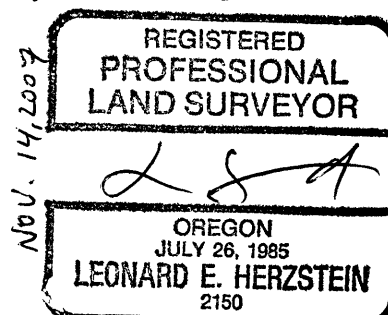

C.S. File No 65/60-51