

OREGON CORNER RESTORATION FORM

Date: 1-9-2007 Piv: XC
This survey consists of:
Map: 2007-0004 A&B
Narrative:
Corner Exp: 65/60-1A&B

Section: 18 Township: 29S Range: 5W

County: Douglas Date: 1-07-07

DOUGLAS COUNTY
SURVEYOR

Corner Designation

NE 1/16TH
S18

- Condition Report Only
- Not Found
- Renewed
- Unrecorded
- Surveyed In
- Referenced Out

Previous Renewals / Surveys, etc.:

N/A

Monument (s) & Accessories Found: (Condition & Source)

N/A

Monument Detail:



Sketch:

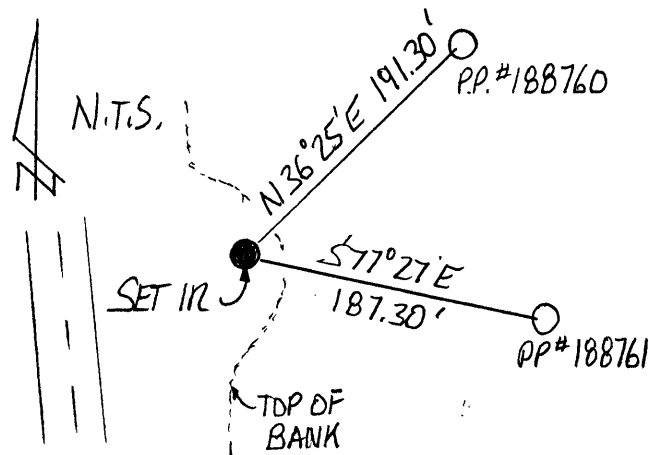

Monument Set (Procedures and Description)

Set a 5/8" x 30" iron rod with plastic cap marked "LANG SURVEYING".

New Accessories

Power pole #188760 bears N36°25'E 191.30'
Power pole #188761 bears S77°27'E 187.30'

SEE 2007-0004 A&B

Location & Comments

Corner falls easterly of Dole Road below the top of the bank.

Compass Declination: N/A

Firm/Agency:

Gregory D. Lang, Surveyor
Address: 7550 Willis Cr. Rd.
Winston, Oregon 97496

Party Chief: Greg Lang

Notes: Same

Witness: Trevor Lang

Surveyor's Seal

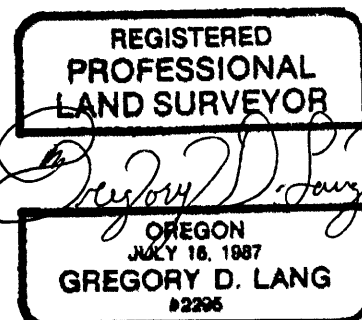

EXPIRES 12-31-08

C.S. File No 65/60-1B