

FILED

Date: 4-3-07 By: JC

This survey consists of:

Map: _____

Narrative: _____

Corner Fpt: 65/60-17 A-B

OREGON CORNER RESTORATION FORM

Section 18 Township 23S Range 5W

County DOUGLAS Date 3-6-07

DOUGLAS COUNTY SURVEYOR

Corner Designation

100400
13 | 18
24 | 19

- Condition Report Only
- Not Found
- Renewed
- Unrecorded
- Surveyed In
- Referenced Out

Previous Renewals/Surveys, etc. _____

Monument(s) & Accessories Found: (Condition and Source)

- 1993³ BLM - IPBC
- 1853 18" FIR Root Crown SSE 18 LKS - NO MARKS VISIBLE
- 1853 36" FIR STUMP S63W 26 LKS - VISIBLE SCRIBE
- 1993³ 1993³ 1993³ FIR Root Crown NB2W 25 LKS - ROTTEN
- 1993 11" FIR N49E 42 1/2 LKS - DOWN
- 1993 14" FIR S28E 41 1/2 LKS - DOWN
- 1993 20" FIR S35W 19 1/2 LKS - DOWN
- 1993 15" FIR NB2W 36 1/2 LKS - DOWN (OVER)

Monument Detail

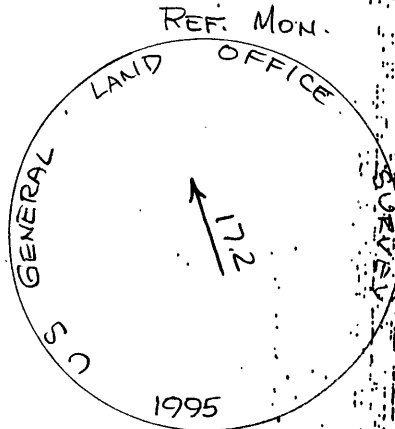
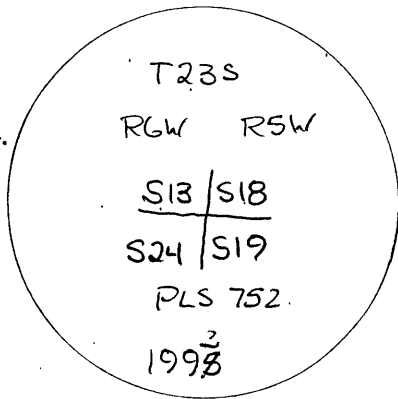

Sketch

Monument Set (Procedures and Description)

New Accessories

- 24" FIR S4W 42.0' SCRIBED "S24 BT"
- 19" FIR S12W 7.9' SCRIBED "S24 BT"
- 19" FIR N50W 29.1' SCRIBED "S13 BT"

Location & Comments

Compass Declination 16 1/2
 Firm/Agency ROSEBURG FOREST PRODUCTS
 Address P O Box 1088 ROSEBURG OR 97470
 Party Chief Bill Olson
 Notes _____
 Witness KEN CORLE

Surveyor's Seal

REGISTERED PROFESSIONAL LAND SURVEYOR

Mark F. Smalley

OREGON JULY 26, 1988 MARK F. SMALLEY 2354

Renews 6/30/08 over

C.S. File No 65/60-17 A

Monument accessories found
① 1943 BLM IPBC Remark'd to read US GLO SURVEY
17.2, 1995 and an arrow

② the section corner is 1993 (NOT 1995) - set by Peel.
the Reference monument is 1995, - remark'd by the BLM.
This my understanding from the field notes.

maximally