

FILED

Date: 3/12/2007 By: JL

This survey consists of:

Map: _____

Narrative: _____

Corner Rpt: 65/60-13

OREGON CORNER RESTORATION FORM

Section 20 Township 25S. Range 4W.

County DOUGLAS Date 3/1/2007

**DOUGLAS COUNTY
SURVEYOR**

Corner Designation

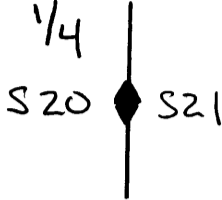

- Condition Report Only
- Not Found
- Renewed
- Unrecorded
- Surveyed In
- Referenced Out

Previous Renewals/Surveys, etc. HAINES MAP M 2 - 14

Monument(s) & Accessories Found: (Condition and Source)

FOUND 1" X 3" CHANNEL IRON 0.2 FEET BELOW GROUND

-- 26" CEDAR BEARS N87 1/4° W 188.9 FEET (RECORD N86° 35' W 188.7 FEET)

HEALED FACE AND TAG

-- 19" OAK BEARS N44 1/2° E 80.7 FEET (RECORD N45° E 81.5 FEET) HEALED

FACE AND TAG

Monument Detail

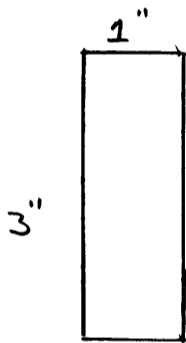

Sketch

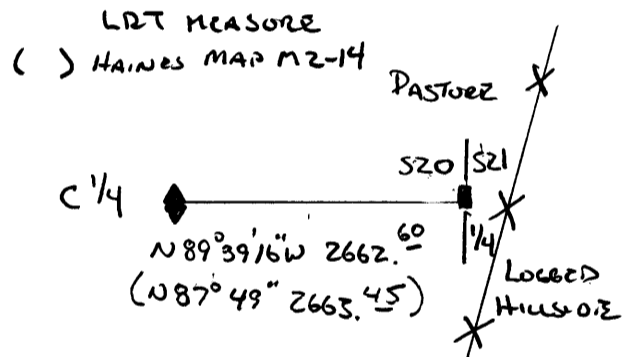

Monument Set (Procedures and Description)

New Accessories

-- SET 5/8" X 40" IRON ROD WITH YELLOW PLASTIC CAP MARKED LONE ROCK
TIMBER PLS 2291 BEARS S5°51' W 38.82 FEET IN FENCE LINE

-- SET 5/8" X 40" IRON ROD WITH YELLOW PLASTIC CAP MARKED LONE ROCK
TIMBER PLS 2291 BEARS N26°27' W 103.82 FEET IN FENCE LINE

Location & Comments

CORNER LIES 0.2
FEET BELOW
GROUND IN
PASTURE FENCE
LINE BEARS EAST
APPROX. 10.7 FT.

BASIS OF BEARING	<u>GPS</u>
Firm/Agency	<u>LONE ROCK</u>
	<u>TIMBER</u>
Address	<u>P.O. BOX 1127</u>
	<u>ROSEBURG, OR. 97410</u>
Party Chief	<u>KEN HOFFINE</u>
Notes	<u>GARY ANGIOLET</u>
Witness	<u>IGNACIO ROMAN</u>

Surveyor's Seal

**REGISTERED
PROFESSIONAL
LAND SURVEYOR**

Ken W Hoffine

**OREGON
JULY 18, 1987
KEN W. HOFFINE
2291**

Expires 6-30-07

C.S. File No 65/60-13