

OREGON CORNER RESTORATION FORM

FILED

Date: 5/22/2006 By: X

This survey consists of:

Map: M150-53

Narrative: _____

Corner Rpt: 65/58-17A-D

Section: 31 Township: 30S Range: 6W

County: Douglas Date: 5-16-06

Corner Designation

S1/16TH S31|S32

- Condition Report Only
- Not Found
- Renewed
- Unrecorded
- Surveyed In
- Referenced Out

DOUGLAS COUNTY
SURVEYOR

Previous Renewals / Surveys, etc.:

This 1/16th corner was established by Victor Mclind in 1973. It was later found and field located by Mark Smalley as shown on survey M112-52.

Monument (s) & Accessories Found: (Condition & Source)

No monument was found.

A 15 1/2" Madrone per M48-27 bears N54 1/2°E 36.50 feet from the newly set monument.

An 18 1/2" Madrone per M48-27 bears S53 1/2°W 20.60 feet from the newly set monument.

NOTE: There are spikes in the base of these bearing trees for measuring distances to the corner; bearings to the trees were measured with a total station & are based on the original survey line between the Section corners.

Monument Detail:

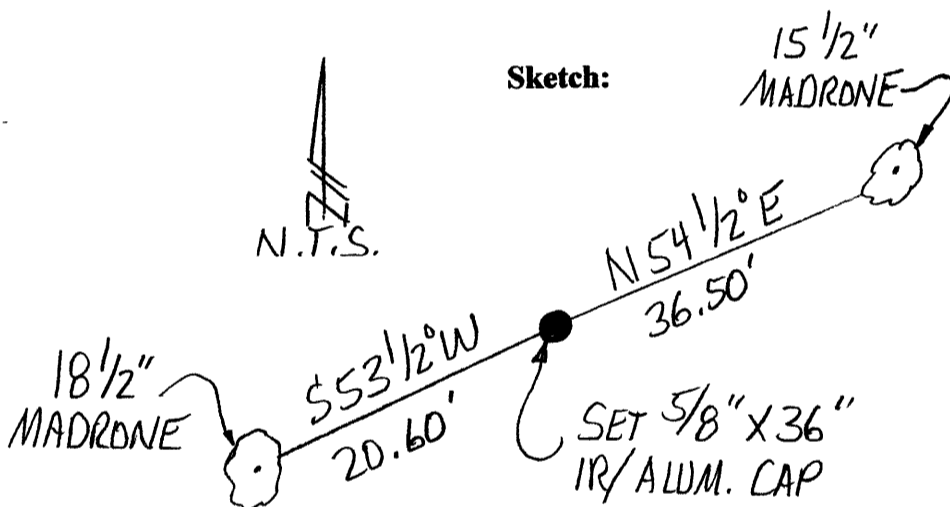
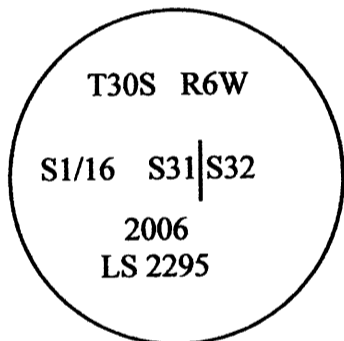

Monument Set (Procedures and Description)

Set a 5/8" x 36" iron rod with aluminum Roseburg Resources cap.

New Accessories

N/A

Location & Comments

Corner lies 350' South of a logging road on the southwest-erly side of a gentle ridge.

Compass Declination: N/A

Firm/Agency:

Gregory D. Lang, Surveyor

Address: 7550 Willis Cr. Rd.

Winston, Oregon 97496

Party Chief: Greg Lang

Notes: Same

Witness: Trevor Lang

Surveyor's Seal

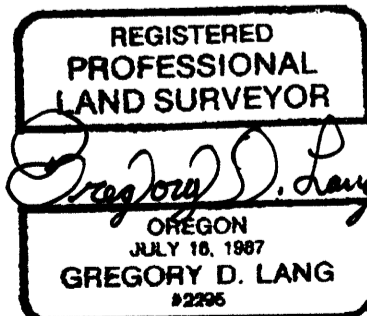

EXPIRES 12-31-06

C.S. File No 65/58-17C