

OREGON CORNER RESTORATION FORM

Section: 22 Township: 30S Range: 03W
 County: Douglas Date: 8-09-05

FILED
 Date: 8-16-2005 By: J
 This survey consists of:
 Map: _____
 Narrative: _____
 Corner Rpt: 65/54-31
DOUGLAS COUNTY SURVEYOR

Corner Designation

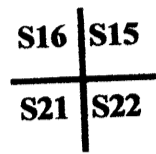

- Condition Report Only
- Not Found
- Renewed
- Unrecorded
- Surveyed In
- Referenced Out

Previous Renewals / Surveys, etc.:

GLO in 1893 by William Bushey; Original corner was perpetuated by BLM in 1972; This corner was also found and used by BLM in their 1986 survey.

Monument (s) & Accessories Found: (Condition & Source)

Found a BLM brass cap and bearing trees per their 1972 survey.
 10 1/2" fir bears N35 1/2°W 29.60' (BLM's 1972 record is N36 1/2°W 31.68')
 12" fir bears N56°E 17.20' (BLM's 1972 record is N55 1/2°E 17.49')
 12 1/2" fir bears S29 1/2°W 14.80' (BLM's 1972 record is S28°W 15.18')
 12" fir bears S40 1/2°E 9.30' (BLM's 1972 record is S41°E 9.57')

Monument Detail:

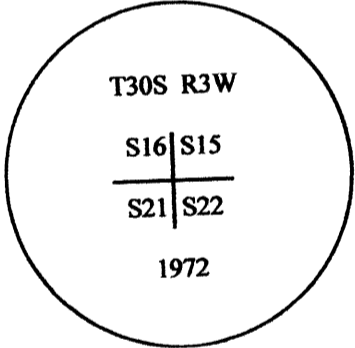

Monument Set (Procedures and Description)

N/A

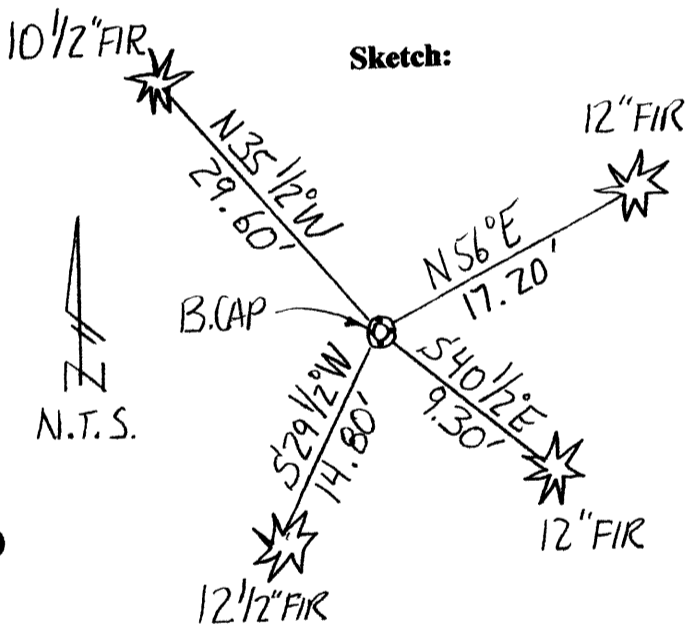

New Accessories

NOTE: We set and measured to spikes in the base of all bearing trees; bearings to the trees are based on BLM's survey of the West line of Section 22.

Location & Comments

Corner is located on the north-west side of a ridge about 550' south of the creek.

Compass Declination: N/A

Firm/Agency:
 Gregory D. Lang, Surveyor
Address: 7550 Willis Cr. Rd.
 Winston, Oregon 97496
Party Chief: Trevor Lang

Notes: Same

Witness: Joel Herzberg

Surveyor's Seal



EXPIRES 12-31-2006

C.S. File No 65/54-31