

FILED

OREGON CORNER RESTORATION FORM

Date: 7-13-2005 By: JC

This survey consists of:

Map: M148-10

Narrative:

Corner Fmt: 65/54-26A+D

Section: 8 Township: 30S Range: 6W

County: Douglas Date: 7-06-05

DOUGLAS COUNTY
SURVEYOR

Corner Designation

1/4 S7|S8

- Condition Report Only
- Not Found
- Renewed
- Unrecorded
- Surveyed In
- Referenced Out

Previous Renewals / Surveys, etc.:

Original by Addison Flint in 1855; midpoint set by Markham in 1955; the original was reset in 1963 by BLM from original evidence.

Monument (s) & Accessories Found: (Condition & Source)

Found Brass Cap set by BLM and a dead yew tree to the northwest per their 1963 renewal.

Monument Detail:

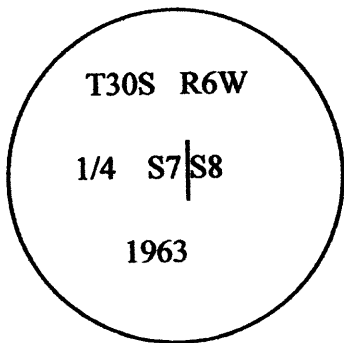

Sketch:

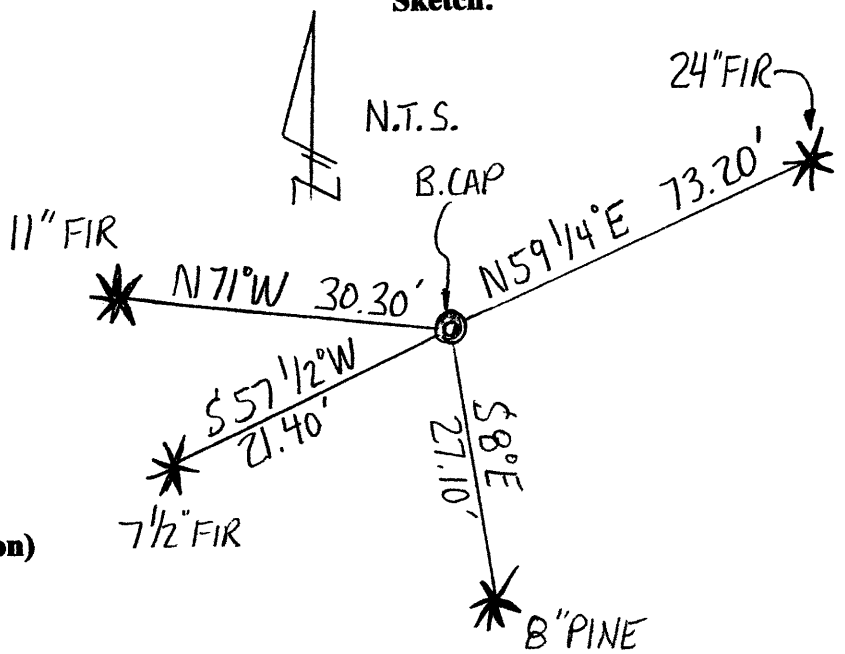

Monument Set (Procedures and Description)

N/A

New Accessories

- 8" Pine bears S 8° E 27.10 feet scribed "1/4 S8 BT"
- 7 1/2" Fir bears S 57 1/2° W 21.40 feet scribed "1/4 S7 BT"
- 11" Fir bears N 71° W 30.30 feet scribed "1/4 S7 BT"
- 24" Fir bears N 59 1/4° E 73.20 feet scribed "1/4 S8 BT"

NOTE: (we set spikes in the base of all new bearing trees for measuring distances to the corner; bearings to the trees were measured with a total station & are based on the 1965 & 1982 BLM plats.)

Surveyor's Seal

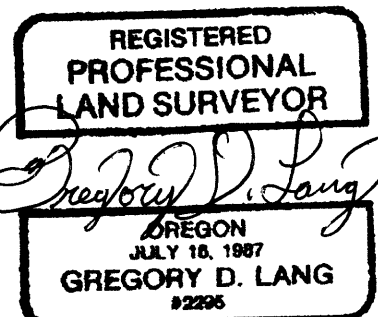

EXPIRES 12-31-06

C.S. File No 65/54-26D

Location & Comments

Corner lies in a small flat west of swamp.

Compass Declination: N/A

Firm/Agency:

Gregory D. Lang, Surveyor
Address: 7550 Willis Cr. Rd.
Winston, Oregon 97496

Party Chief: Trevor Lang

Notes: Same

Witness: Joel Herzberg