

OREGON CORNER RESTORATION FORM

Section: 31 **Township:** 28S **Range:** 05W

County: Douglas **Date:** 6-19-05

FILED

Date: 7-1-2005 By: DL
 This survey consists of:
 Map: M148-4
 Name: _____
 Corner Rpt: 65/54-25 E

Corner Designation

1/4 S31 | S32

- Condition Report Only
- Not Found
- Renewed
- Unrecorded
- Surveyed In
- Referenced Out

DOUGLAS COUNTY
SURVEYOR

Previous Renewals / Surveys, etc.:

GLO in 1853 by Elder & Gile; Corner was set by proportion in 1976 (see M56-41).

Monument (s) & Accessories Found: (Condition & Source)

Found 3/4" Iron Pipe set in 1976 per M56-41
 Existing 18" D.Fir bears S55°W 7.50'
 Existing 18 1/2" D.Fir bears N33°E 31.55'

Monument Detail:

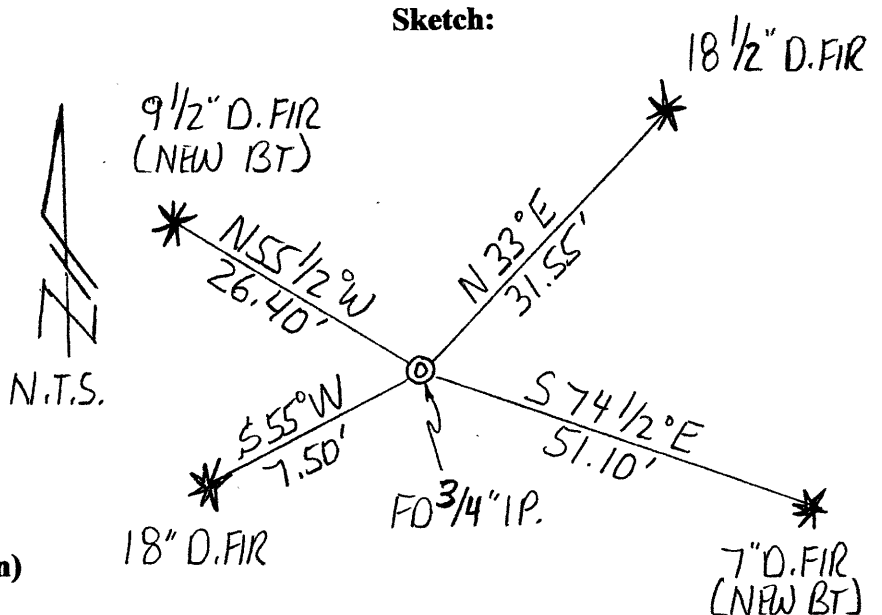
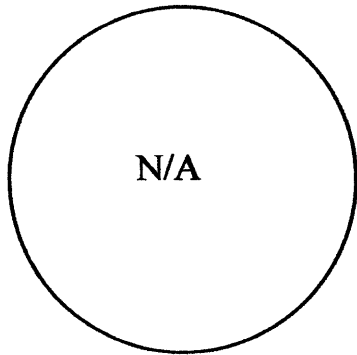

Monument Set (Procedures and Description)

New Accessories

9 1/2" D.Fir bears N55 1/2°W 26.40' scribed "1/4 S31 BT"
 7" D.Fir bears S74 1/2°E 51.10' scribed "1/4 S32 BT"

NOTE: We set and measured to spikes in the base of all bearing trees; bearings to the trees are based on our 2005 survey referenced hereon.

Location & Comments

Corner is located on a north-erly slope approximately 550' South of Clarks Branch County road.

Compass Declination: N/A

Firm/Agency:

Gregory D. Lang, Surveyor
 Address: 7550 Willis Cr. Rd.
 Winston, Oregon 97496

Party Chief: Gregory Lang

Notes: Same

Witness: Trevor Lang

Surveyor's Seal

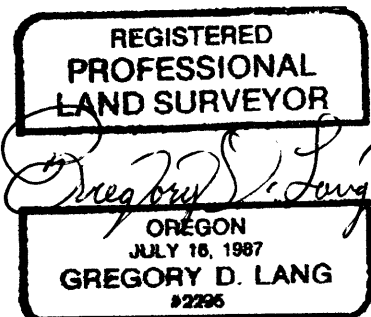

EXPIRES 12-31-2006

C.S. File No 65/54-25 E