

GARY T. SMITHER

Professional Land Surveyor
Certified Water Rights Examiner

FILED

Date: 6-1-2005 By: JC
This survey consists of:
Map: _____
Number of: _____
Corner Ref: 65/54-22

DOUGLAS COUNTY
SURVEYOR

Township 21 South, Range 8 West Section 36

Southwest Corner for Section 36: Found 1952 Brass Cap on Iron Pipe firmly set with a steel fence post driven alongside the Brass Cap.

Old Bearing Trees:

51" Fir Stump, N 64° W, 8.5 feet, with old tag, no marks (Record N70°W, 10 links).

64" Fir Stump, N 24° E, 15.2 feet, no marks (Record N20°E, 20 links).

12" Fir Stump, N39°W, 28.6 feet, rotted with no markings.

1999 Bearing Trees:

12" D. Fir, N 67° E, 12.7 feet to spike in side center, with healed face and bearing tree tag.

9" D. Fir, N 33° W, 14.0 feet to spike in side center, with healed face and bearing tree tag.

9" D. Fir, S 83° W, 30.4 feet to spike in side center, with healed face and bearing tree tag.

20" D. Fir, S 10° E, 30.2 feet to spike in side center, with healed face and bearing tree tag.

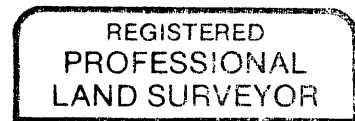

Gary T. Smither

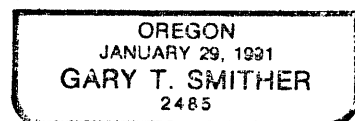

Renew 6/06

988-2214

FAX and Phone (541)-*751-9624*
P.O. Box 545, North Bend, OR 97459

C.S. File No 65/54-22