

**OREGON CORNER RESTORATION FORM**

FILED

Date: 5/18/2005 By: HW  
 This survey consists of:  
 Map: M 147-60  
 Narrative: \_\_\_\_\_  
 Corner Rpt: CS 65/54-17

Section: 09 Township: 29S Range: 06W

County: Douglas Date: 05-10-05

DOUGLAS COUNTY  
SURVEYOR

Corner Designation

**C 1/4 S9**

- Condition Report Only
- Not Found
- Renewed
- Unrecorded
- Surveyed In
- Referenced Out

**Previous Renewals / Surveys, etc.:**

Originally set during BLM survey by Robert J. Chappel under Group #1616, surveyed June 24 - Sept. 16, 1991

**Monument (s) & Accessories Found: (Condition & Source)**

Found BLM brass cap 2 1/2 inches in diameter.

A 20" fir bears N47 1/2°E 40.59'

A 21" fir bears S17°W 77.88'

Both have healed faces & are in good condition.

**Monument Detail:**

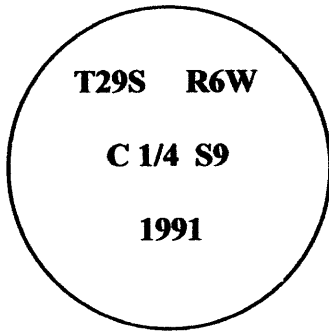

**Sketch:**

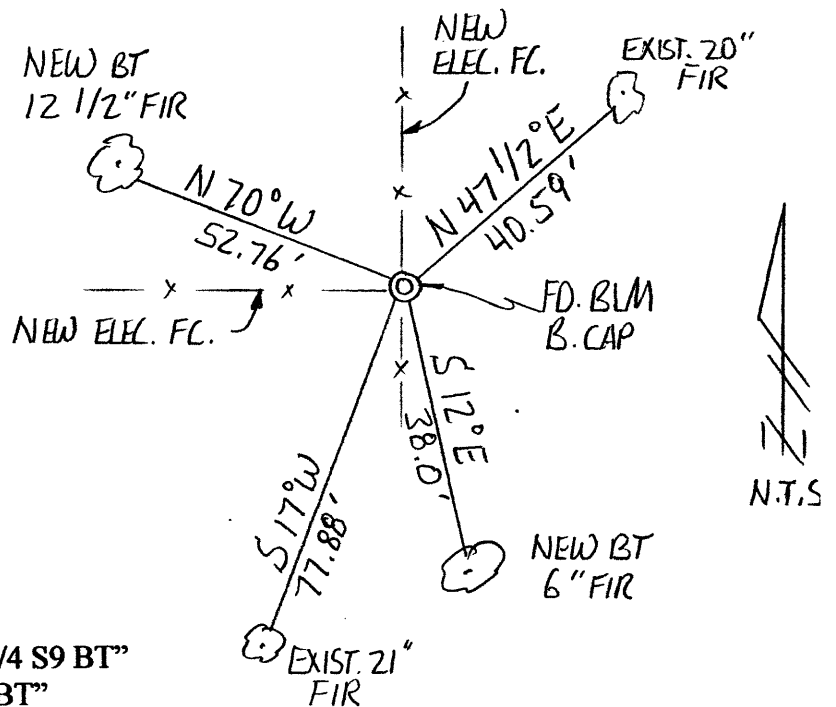

**Monument Set (Procedures and Description)**

N/A

**New Accessories**

A 12 1/2" Fir bears N70°W 52.76' scribed "C1/4 S9 BT"

A 6" Fir bears S12°E 38.00' scribed "C1/4 S9 BT"

Distances given are to spikes set below stump height in the side of the tree.

**Location & Comments**

Corner is located at a fence junction with fences running North, West, and South. It lies on a northwest slope, just northerly of a thicket of reproduction fir.

Compass Declination: N/A

**Firm/Agency:**

Gregory D. Lang, Surveyor

Address: 7550 Willis Cr. Rd.

Winston, Oregon 97496

Party Chief: Gregory Lang

Notes: Same

Witness: Trevor Lang

**Surveyor's Seal**



EXPIRES 12-31-2006

C.S. File No 65/54-17