

OREGON CORNER RESTORATION FORM

Section: 3 Township: T22S Range: R8W
 County: Douglas Date: January 13, 2005

FILED
 Date: 1-25-2005 By: JC
 This survey consists of:
 Map: _____
 Narrative: _____
 Corner Rpt: 65/54-3

DOUGLAS COUNTY
 SURVEYOR

Corner Designation

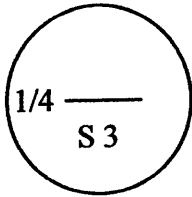

- Condition Report Only
- Not Found
- Renewed
- Unrecorded
- Surveyed In
- Referenced Out

Previous Renewals / Surveys, etc.:

Set in 1952 by BLM

Monument (s) & Accessories Found: (Condition & Source)

Found Brass Cap and Bearing Trees set in 1952;
 A 43 1/2" Fir bears S62°E 33.73' (S63°E 34.32')
 A 42" Fir bears S8 1/2°W 81.67' (S7°45'W 81.84')

Monument Detail:

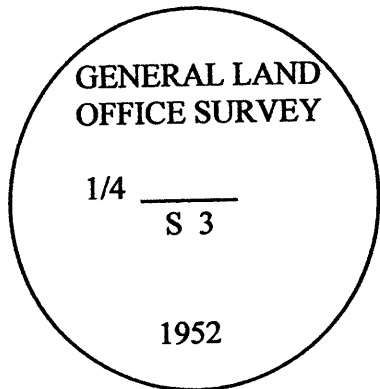

Monument Set (Procedures and Description)

N/A

Sketch:

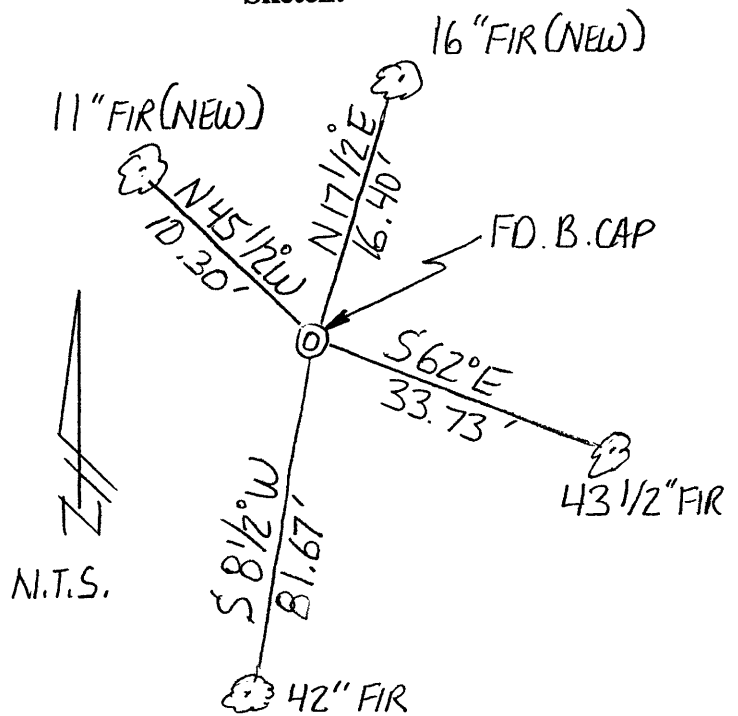

New Accessories

A 11" D. Fir bears N45 1/2°W 10.30' scribed "BT"
 A 16" D. Fir bears N17 1/2°E 16.40' scribed "BT"

Location & Comments

Corner is located on a steep southwest slope, 160' easterly of a tributary to Cedar creek.

Compass Declination: N/A

Firm/Agency:

Gregory D. Lang, Surveyor
 Address: 7550 Willis Cr. Rd.
 Winston, Oregon 97496
 Party Chief: Gregory Lang

Notes: Same

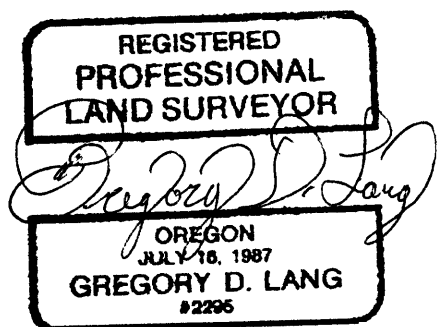

EXPIRES: 12-31-06
 C.S. File No 65/54-3