

OREGON CORNER RESTORATION FORM

FILED

Section: 16 Township: 30S Range: 03W

Date: 10-15-2004 Rev: X

County: Douglas Date: 10-12-04

This survey consists of:
 Map: _____
 No. _____
 Corner Rpt: 65/52-14

Corner Designation

1/4 $\frac{S16}{S21}$

- Condition Report Only
- Not Found
- Renewed
- Unrecorded
- Surveyed In
- Referenced Out

DOUGLAS COUNTY
SURVEYOR

Previous Renewals / Surveys, etc.:

See original GLO survey notes by Bushey in 1893. Also see BLM resurvey in 1972; the original corner and its accessories were not found; they reset it by proportion.

Monument (s) & Accessories Found: (Condition & Source)

Found 3 1/2" BLM Brass cap
 24 1/2" D. Fir bears N33 3/4*W 57.50'
 25" D. Fir bears S44 1/2*W 60.30'

Monument Detail:

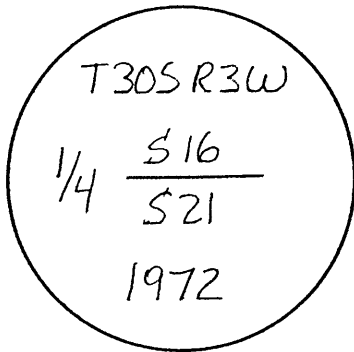

Sketch:

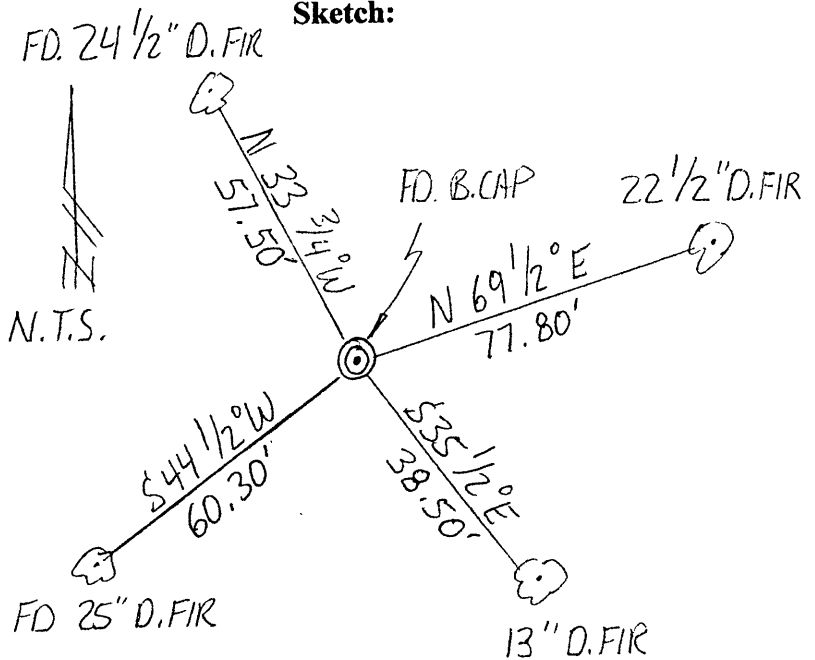

Monument Set (Procedures and Description)

N/A

New Accessories

22 1/2" D. Fir bears N69 1/2*E 77.80' scribed "1/4 S16 BT"
 13" D. Fir bears S35 1/2*E 38.50' scribed "1/4 S21 BT"

NOTE: We set and measured to spikes in the base of all bearing trees; bearings to the trees are based on BLM's 1972 survey line from the N1/4 Corner to the NW Section Corner of Section 21 (S89*41'00"W).

Location & Comments

Corner lies on the top of a ridge & in a dirt road.

Compass Declination: N/A

Firm/Agency:

Gregory D. Lang, Surveyor
 Address: 7550 Willis Cr. Rd.
 Winston, Oregon 97496

Party Chief: Gregory Lang

Notes: Same

Witness: Trevor Lang

Surveyor's Seal

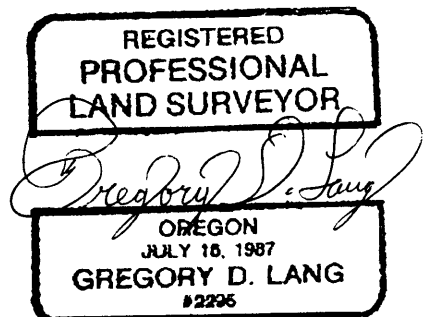

EXPIRES 12-31-2004

C.S. File No 65/52-14