

**OREGON CORNER RESTORATION FORM**

Section 10 Township 25S Range 5W County Douglas

FILED  
Date: 8/24/2004 By: X  
Date: 8/04  
This survey consists of:

**Corner Designation**

1/4 Corner  
Between Sections 3 & 10

- Condition Report On
- Not Found
- Unrecorded
- Surveyed In
- Referenced Out

Map: \_\_\_\_\_  
Narrative: \_\_\_\_\_  
Corner Rpt: 65/52-8

**DOUGLAS COUNTY  
SURVEYOR**

**Previous Renewals/Surveys, etc**

Elder & Gile originally set a 1/4 Sec. Post, from which: A fir, 5" dia. bears N20°W, 46 lks. dist. A Y. Oak 4" dia. Bears S341/2°W, 37 lks dist.

Thiel returned in 1900 and set a sawed post & buried a brick alongside from which a Fir 18" dia. bears N35°W, 40 lks. from which a fir 20" dia. bears S36°E, 50 lks. Thiel also remarked the NW BT as he knew it to be an original for 18 years.

**Monument (s) & Accessories Found**

Found a 5/8" iron rod, 0<sup>8</sup> feet East of newest barbed wire fence, and uncovered to 0<sup>1</sup> feet above ground. Also found 24" Doug-Fir with Burt Holt tag that calls this tree as the corner tree (0<sup>0</sup> feet to the corner). Also found a 1946 BLM tag on same 24" Doug-Fir which calls this tree as the corner tree. This tree bears S22°36'56"W at a distance of 10<sup>69</sup> feet from the iron rod.

**Monument Detail**

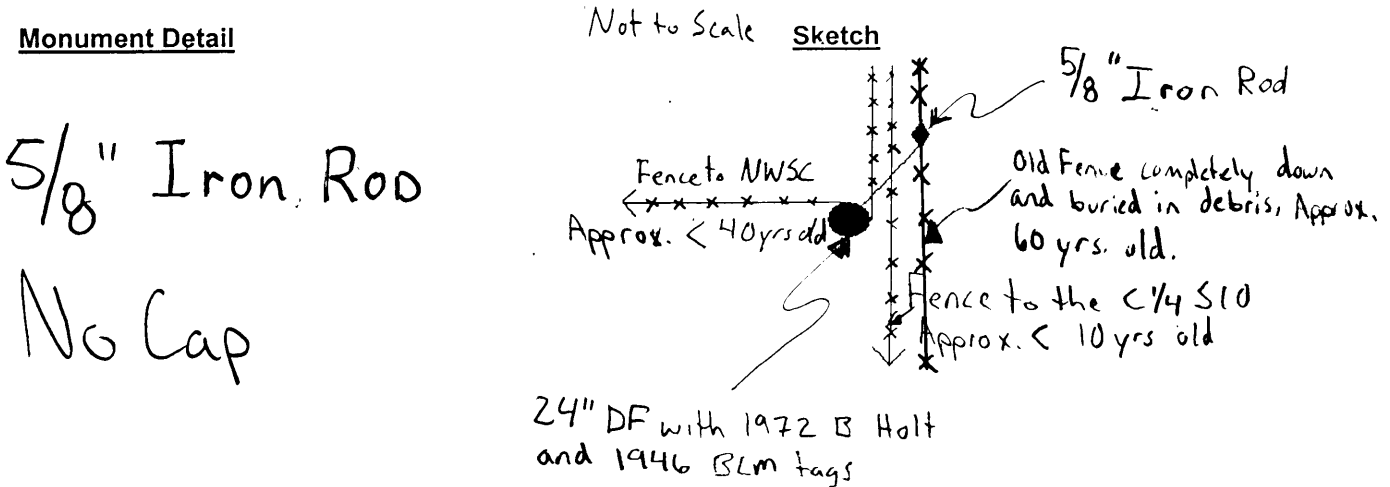

**Location (Procedures and Description)**

A preliminary open ended GPS & Transit survey was conducted to establish the position of the fences, marked corner tree, and old stumps for original and Thiel 1900 renewal search. Our search yielded the following position of an unrecorded 5/8" iron rod. The iron rod lies in the remains of a very old, approximately 60 years old, barb wire fence line that was completely down and buried in debris. We found no conclusive evidence to renew either the original or Thiels renewal location. The position of the unrecorded iron rod is N89°48'11"E and 2642<sup>0</sup>, from the NWSC of S10. The unrecorded rod also bears S89°49'38"W and 2640<sup>9</sup> feet from the NESC of S10.

**New Accessories**

We made 2 BT's for the found 5/8" iron rod.  
A 24" Doug-Fir which bears S22°37'W and 10<sup>69</sup> ft., scribed "BT" in face.  
A 17" Doug-Fir which bears N0°57'W at 20<sup>28</sup> ft., scribed "BT" in face. Tree blazed as line tree.

**Location and Comments**

5/8" Iron Rod found on East facing slope ~ 120 ft. from the foot of the hill, in second growth stand of Douglas Fir

Compass Declination: 19 1/2°  
Firm/Agency: Lone Rock Timber Mgmt Co.  
Address: PO Box 1127 Roseburg, OR 97470  
Party Chief: Ken Hoffine  
Notes:  
Witness: Pat Carter

Surveyor's Seal

REGISTERED  
PROFESSIONAL  
LAND SURVEYOR

*Ken W Hoffine*

OREGON  
JULY 16, 1987  
KEN W. HOFFINE  
2291

Expires 6-30-05

C.S. FILE NO 65,52-8