

# OREGON CORNER RESTORATION FORM

FILED

Date: 8/23/2004 By: X  
 This survey consists of:  
 Map: \_\_\_\_\_  
 Name: \_\_\_\_\_  
 Corner File: 65/52-5

Section: 26 Township: 31S Range: 8W

County: Douglas Date: 8-18-04

Corner Designation

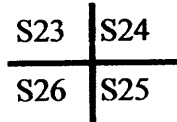

- Condition Report Only
- Not Found
- Renewed
- Unrecorded
- Surveyed In
- Referenced Out

DOUGLAS COUNTY  
SURVEYOR

**Previous Renewals / Surveys, etc.:**

See renewal by the Douglas County Surveyor's Office in 1967; also renewal by Mark Smalley in 7/2002

**Monument (s) & Accessories Found: (Condition & Source)**

Found Brass Cap set by Douglas County

- A 36" Fir bears S 77 1/2°E 28.07 feet (2002 by Mark Smalley)
- A 38" Fir bears S 36°E 27.37 feet (2002 by Mark Smalley)
- A 28" Fir bears N 22°W 24.00 feet (original)
- A 42" Fir stump bears S 48 3/4°W 17.63 feet (2002 by Mark Smalley)
- The broken off maple clump is still in existence to the southeast

**Monument Detail:**

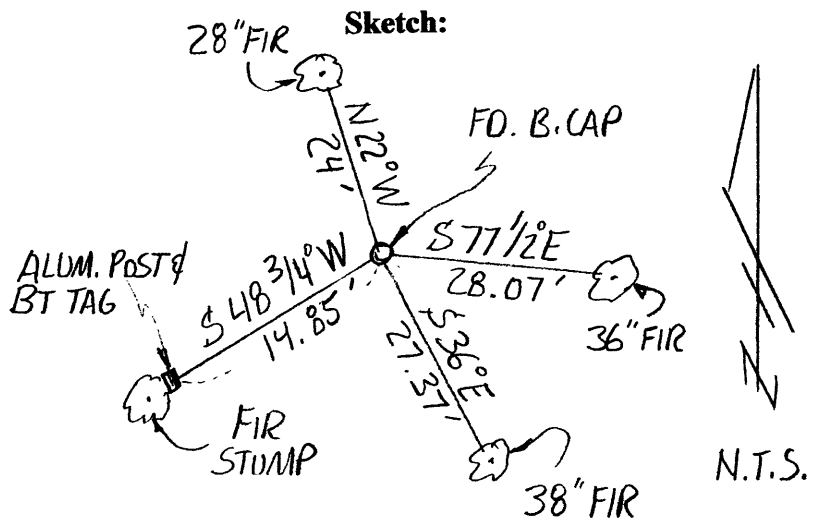
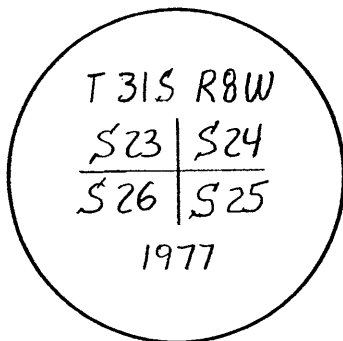

**Monument Set (Procedures and Description)**

N/A

**New Accessories**

An aluminum post with a BT tag (bearing object) bears S 48 3/4° W 14.85 feet

NOTE: (we set a spike in the base of the original bearing tree noted above; there are also nails in the two trees scribed by Mark Smalley for measuring distances to the corner; bearings to trees were measured with a total station & are based on the 1977 resurvey of the north line of Section 26)

Compass Declination: N/A

**Location & Comments**

Corner lies on a northwesterly slope above Cow Creek road.

**Firm/Agency:**

Gregory D. Lang, Surveyor  
 Address: 7550 Willis Cr. Rd.  
 Winston, Oregon 97496  
 Party Chief: Gregory Lang  
 Notes: Same  
 Witness: Trevor Lang

**Surveyor's Seal**

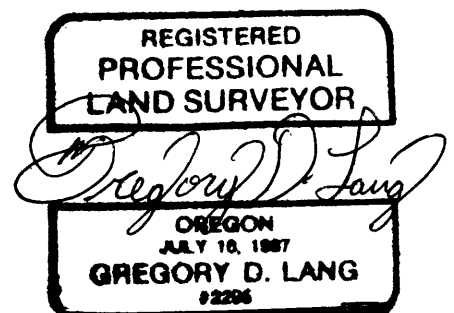

C.S. File No 65/52-5 EXPIRES 12-31-04