

FILED

Date: 5-3-2004 By: JC

This survey consists of:

Map: \_\_\_\_\_

Narrative: \_\_\_\_\_

Corner Rpt: 65/49-33

DOUGLAS COUNTY SURVEYOR

OREGON CORNER RESTORATION FORM

Section 30 Township 29S Range 7W

County DOUGLAS Date 5-3-04

Corner Designation

- Condition Report Only
- Not Found
- Renewed
- Unrecorded
- Surveyed In
- Referenced Out

Previous Renewals/Surveys, etc.

1924 GLO BY MENSCH; COUNTY SURVEYOR 1962 (CS49/139); & 1988/89 BLM RECONVEY

Monument(s) & Accessories Found: (Condition and Source)

FOUND 1924 GLO BRASS CAP  
14" W. FIR BEARS S 72 1/2° W 6.93' BY BLM IN 88/89  
(GOOD CONDITION)

Monument Detail

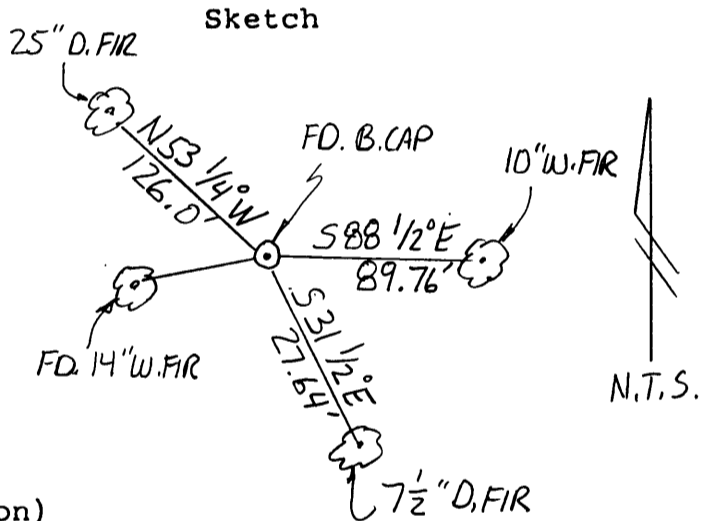

Monument Set (Procedures and Description)

N/A

New Accessories

25" D. FIR BEARS N 53 1/4° W 126.0' SCRIBED "1/4 S 19 BT"  
7 1/2" D. FIR BEARS S 31 1/2° E 27.64' SCRIBED "1/4 S 30 BT"  
10" W. FIR BEARS S 88 1/2° E 89.76' SCRIBED "1/4 S 19 BT"

Location & Comments

CORNER LIES ON A  
FLAT BENCH, NORTH &  
WEST OF COARSE COLD  
CREEK.

Compass Declination N/A  
 Firm/Agency \_\_\_\_\_  
GREGORY D. LANG  
 Address 7550 WILLIS CR. RD.  
WINSTON OR. 97496  
 Party Chief G. LANG  
 Notes SAME  
 Witness T. LANG

Surveyor's Seal

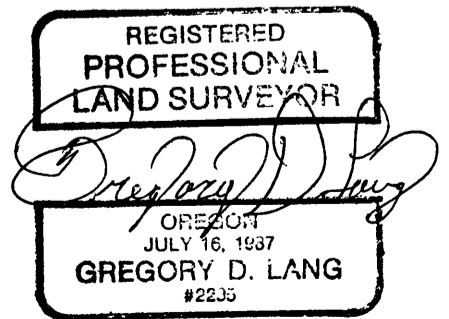

EXPIRES 12-31-04

C.S. File No 65/49-33