

**REWITNESSED CORNER FOR  
STATE OF OREGON – DEPARTMENT OF FORESTRY**

South one sixteenth corner common to Sections 23 and 24, Township 23 South,  
Range 10 West, W.M., Douglas County, Oregon.

**ESTABLISHED by Gregory K. Miller, 1983**

2 ½" galvanized iron pipe with 2 ½" brass cap (in place) from which a:

18" Fir N35°E 7.5 ft.; now 20" x 4 ft. high stump in place, face closed,  
Champion Timberlands tag.

18" Fir N02°W 7.7 ft.; now 22" in place, face closed, Champion Timberlands  
tag.

Oregon State Board of Forestry 1 ½" galvanized iron pipe with 3" bronze cap,  
1967, S2°20'07"W 5.97 ft.; in place

**REWITNESSED from the above 2 ½" pipe and 2 ½" cap:**

Carsonite witness post S80°E 2.65 ft. to base.

Carsonite witness post S80°W 3.50 ft. to base.

Magnetic variation set at 20° east.

Dated April 6, 2004

Rewitnessed by Jim VanVleet under my direction.  
Tim VanVleet

Rewitnessed by:

FILED  
Date: 4/30/2004 By: JC  
This survey consists of:  
Map: \_\_\_\_\_  
Narrative: \_\_\_\_\_  
Corner Rpt: 65/49-30

DOUGLAS COUNTY  
SURVEYOR

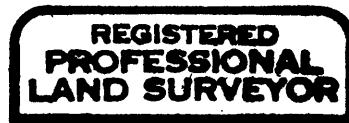

*James M. McIntosh*



James M. McIntosh  
63612 Fifth Road  
Coos Bay, Oregon  
Expiration date of certificate 12-31-04

C.S. File No 65/49-30