

FILED

Date: 3-8-2004 By: JL

This survey consists of:

Map: _____

Narrative: _____

Corner Rpt: 65/49-12

DOUGLAS COUNTY
SURVEYOR

CORNER NOTES

JANUARY 2004

BY: TONY HOSTETTER
63538 PINTAIL DR.
COOS BAY, OR 97420

FOR: WEYERHAEUSER COMPANY
98674 DELLWOOD LANE
COOS BAY, OR 97420

N 1/4 CORNER, SECTION 6, T. 24 S., R. 8 W., W.M.
DOUGLAS COUNTY, OREGON

FOUND: 1967 BRASS CAP BY DOUGLAS COUNTY SURVEYOR AS DESCRIBED
BY TRACY IN 1967. (*DOUGLAS COUNTY SUVEYORS RECORDS 54/12.*)

BOTH BTS MARKED TRACY IN 1967 ARE STUMPS.

WEYCO BTS:

22" HEMLOCK, WEYCO TAG,
BEARS; N 60°E, 4.7 FEET TO "W" NAIL.

10" HEMLOCK, WEYCO TAG,
BEARS; S34°W, 23.3 FEET TO "W" NAIL.

NEW BT:

6" FIR, SCRIBED "S6 1/4 BT", WEYCO TAG,
BEARS: S 13° E, 19.7 FEET TO SPIKE PLACED IN ROOT COLLAR BELOW
SCRIBING.

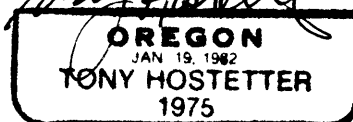
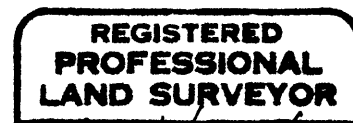

C.S. File No 65/49-12