

Date 11/24/03

GOVERNMENT CORNER RESTORATION FORM

Filed

Date: 12/31/2003 By: J
This survey consists of:

Township 30S Range 0N Corner. S 1/4 PLSS # SEC 31

Map: _____

Geographic Location - south zone

Narrative: _____

Corner Rpt: CS 65/48-47

DOUGLAS COUNTY
SURVEYOR

N: _____ E: _____

Lat: 1 _____ Long: _____

Datum/Adj.: _____ Precision: _____ File # _____ Date: _____ Agency: _____

Previous Renewals _____

Monument(s) Found (Condition and source):

3 1/4" BC ON 2 1/2" PIPE, FUSH, 1962 BLM
GOOD CONDITION

Accessories Found:

36" I. CEDAR N 16° W 32.34 FEET, BARK SCRIBE VISIBLE, TAG
48" D. FIR BT SOUTH 4.2 FEET, BARK SCRIBE VISIBLE, TAG
(4.62) 1962 REC

Monument Set (Procedure and Description):

New Accessories:

14" W. FIR BT N 44° E 15.2 FEET, MARKED "S 1/4 S 31 BT", TAG
17" R. CEDAR BT N 77° W 39.5 FEET, "S 1/4 S 31 BT", TAG

Sketch, Detail, or Location

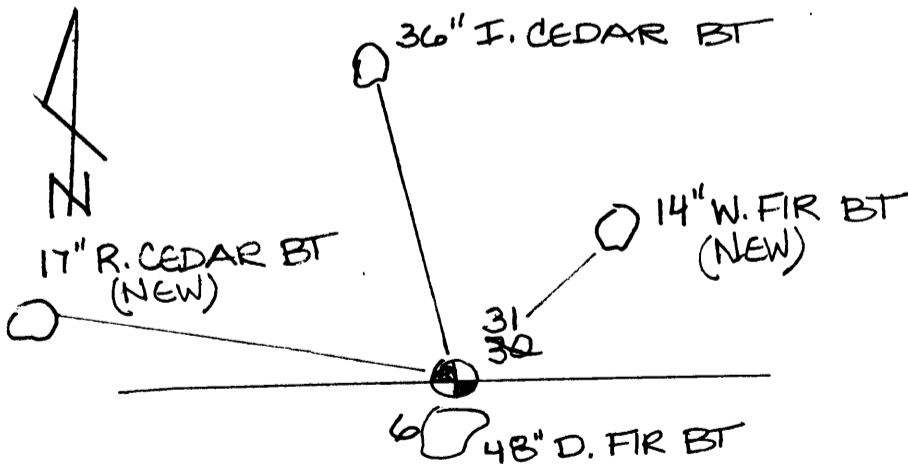

Location & Comments

Compass Declin. 19° EAST
Crew C. SWEEDEN
E. WILDS
SWEEDEN LAND SURVEYING
5211 COLE RD, OAKLAND OR.
Surveyor's Seal & exp. date. 97462



Exp. 6/30/04
C.S. File No 65/48-47