

FILED

Date: 11-14-2003 By: JC

This survey consists of:

Map: _____

Narrative: _____

Corner Rpt: 65/48-41

DOUGLAS COUNTY
SURVEYOR

OREGON CORNER RESTORATION FORM

Section 20 Township 24S Range 7W

County DOUGLAS Date 10-14-03

Corner Designation

18 | 17
19 | 20

- Condition Report Only
- Not Found
- Renewed
- Unrecorded
- Surveyed In
- Referenced Out

Previous Renewals/Surveys, etc. _____

Monument(s) & Accessories Found: (Condition and Source)

FOUND 1960 D.C.S.O. I.P.B.C. 2' TALL LOOSE IN GROUND

BTs: 15" FIR N28E 32³ HEALED

23" W. FIR SNAG NSW 64³ HEALED

8" FIR S86E 34⁰ DOWN-HEALED

Monument Detail

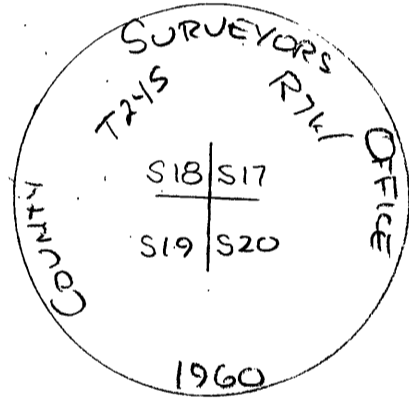

Sketch

Monument Set (Procedures and Description)

New Accessories

12" FIR N86E 29⁶ SCRIBED "S17 BT"

18" W. FIR N34E 26⁶ SCRIBED "S17 BT"

Location & Comments

Surveyor's Seal

Compass Declination 19°

Firm/Agency Roseburg Forest Products

Address PO Box 1088

Roseburg Oregon 97470

Party Chief Bill Olson

Notes _____

Witness Mike Fromdahl

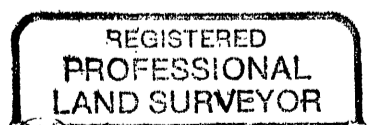

Mark F. Smalley

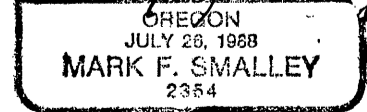

RENEWS 6/30/04

C.S. File No 65/48-41