

CORNER REPORT FORM

Section 8 Township 31S Range 6W.W.M.

Douglas County Date October 19, 2003

CORNER DESIGNATION

300600

- Condition Report only
- Not Found
- Renewed
- Unrecorded
- Surveyed In
- Referenced out

Previous Renewals/Surveys, etc:

Monument(s) & Accessories Found: (Condition and Source)

- 3-1/4" BLM brass cap on 2-1/2" iron pipe 6" above grade.
- A Madrone 24" (27") diameter, bears N68W, 34.4 feet (31.02 feet & 29.70 feet). With tag and old axe marks.
- A fir 18" (17") diameter, bears N62E (N48E), 40.5 (40.9) feet. Now 4+/- foot tall stump still with bark with healed face.
- A fir 23" (30") diameter, bears S74-1/2E, 49.5 feet. Now 5+/- foot tall tin covered stump without bark with healed face and tag.
- A fir 35" (23") diameter, bears N12W, 31.2 (30.4) feet, with healed face and tag.
- A fir 6" diameter, bears S8E, 30.5 feet, face scribed "T31S R6W S8" "BT".
- A 5/8" iron rod with a yellow plastic cap "BTS", bears S72E, 20.1 feet.

Monument Detail

Sketch

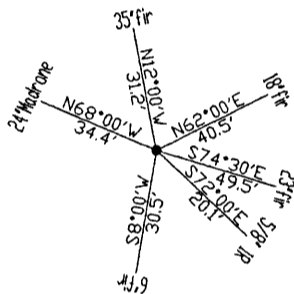
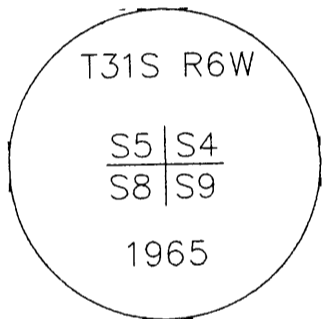

Monument Set (Procedures and Description)

FILED

Date: 11-7-2003 By: SC

This survey consists of:

Map: _____

Name: _____

Corner Ref: 65/48-27

DOUGLAS COUNTY SURVEYOR

New Accessories

Location & Comments

Distances to bearing trees were measured with EDM at approximate side center. Trees were red band and face painted.

Compass Declination 19 East

Firm/Agency: i.e. Engineering, Inc.

Address: 741 SE Jackson
Roseburg, OR 97470

Party Chief: Bruce Webster

Notes:

Witness:

Surveyor's Seal

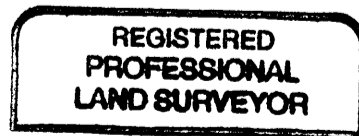

Jerry Lee Estabrook

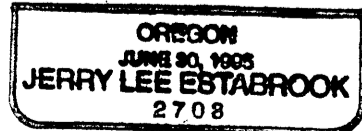

Exp. Date 12-31-03

C.S. File No 65/48-27