

CERTIFIED RECORD OF LAND CORNER MONUMENTATION

History of original corner establishment: T. 32 S., R. 1 W., W. M.
Gerald V. Nygren, Land Surveyor No. 1035, established the North 1/16 corner of sections 1 and 2 in 1993 on Douglas County survey map No. 118-20, C.S file No. 63/134-6 and Jackson County survey No. 13811. He set a 2-1/2 inch diameter aluminum post, 30 inches long, with aluminum cap marked:

He marked bearing trees: a 15" Douglas fir, S. 41° E., 3.9 feet, marked "N1/16 S1 BT", a 9" Douglas fir, S. 85° W., 24.7 feet, marked "N1/16 S2 BT", and a 5/8"x30" iron rod with yellow plastic cap marked "NYGREN LS1034", N. 0° 20' 55" W., 167.49 feet, with a 1/2 inch diameter brass washer, stamped "LS 1035", nailed to the lower blaze of each bearing tree.

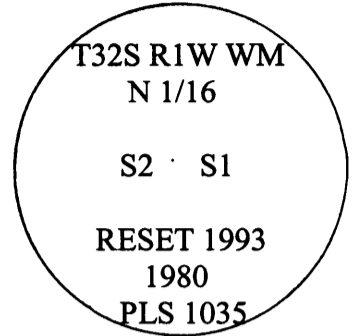

Description of corner evidence found: August 13, 2003
I found a 2-1/2 inch outside diameter aluminum pipe, firmly set, projecting 6 inches above a 3 foot diameter mound of stone, with a 2-1/2 inch diameter aluminum cap marked as shown:

From which the following bearing trees marked by Nygren:

- 16" diam. Douglas fir, bears S. 44° E., 4.1 feet (rec. S. 41° E., 3.9 feet) with a partially healed double blaze.
- 8" diam. Douglas fir snag, bears S. 85° W., 24.7 feet, with fragmentary scribe marks visible on a partially healed double blaze.

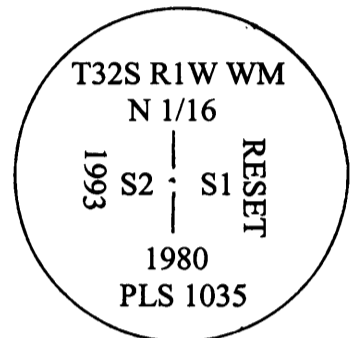

I searched for and did not find the yellow plastic cap.

Description of monument and accessories I established to perpetuate the original location of this corner: August 13, 2003

I add new accessories for this corner:

- A 6-foot steel fence post bears West, 4.2 feet, driven 1.6 feet in the ground with Forest Service signs "Property Boundary" (#54-2) and "Land Survey Monument" (#54-9) attached.
- 26" diam. Douglas fir, bears N. 7°15'W., 11.3 feet, scribed "N1/16 BT" on a single blaze with a 3/4" brass washer, marked "LS 2150", nailed flush to the base of the blaze.

With a 10-second total station, I back sighted a property post placed by Nygren in 1993, approximately 200 feet away, to obtain an initial bearing of S. 89° 51' 40" W. Bearings for this renewal are rounded to the nearest 15 minutes. Trees are measured to the center of the root crown. Tree diameters are at breast height.

Witness: Marcus Felter
Tim Schmid
Brent Knapp
Curtis Ackley

My certificate expires June 30, 2005

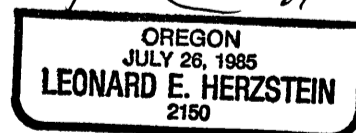
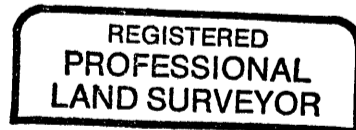

AUG. 27, 2003

FILED

Date: SEP 4 2004 By: JC

This survey consists of:

Map: _____

Narrative: _____

Corner Rpt: 65/48-11

DOUGLAS COUNTY
SURVEYOR