

AFFIDAVIT OF CORRECTION (PLAT)

I, WAYNE L. ROGERS, being duly sworn, depose and say that I am the surveyor who surveyed land partition 2003-0002A as filed and recorded in, Douglas County, Oregon Plat Records INSTRUMENT #2003-000365; and

The following correction to said plat is necessary and is as follows:

1. THE EASEMENT STATEMENT TO ALLOW ACCESS/UTILITIES TO PARCEL 2 (EXTENSION OF PRESCOTT AVENUE) SHOULD READ TO BENEFIT PARCEL 1.
- 2.

The present fee owner(s) of the property materially affected by said Affidavit is(are) as follows:

1. DANNY LANG
PO BOX 459
SUTHERLIN, OR 97479

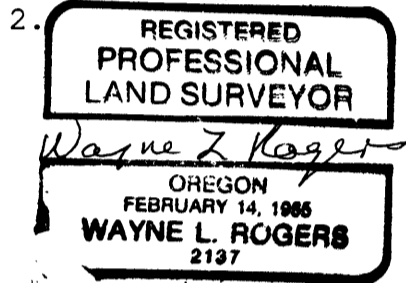

Wayne L. Rogers

 WAYNE L. ROGERS, L.S.
 License No. 2137

STATE OF OREGON)
) ss
 COUNTY OF DOUGLAS)

Subscribed and sworn before me on this 9 day of April, 2003.

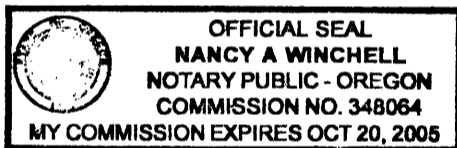

Nancy A. Winchell

 Notary Public for Oregon
 My Commission Expires: 10/20/05

I, ROMNEY WARE, County Surveyor, do hereby certify that said affidavit of Correction for LAND PARTITION 2003-0002A, has been examined by me and that it complies with ORS 92.170 (plats)/ORS 209.255 (surveys).

Romey Ware

 ROMNEY WARE, County Surveyor

FILED

Date: 4/9/2003 By: JP

This survey consists of:

For Map: 2003-0002A

Name of: _____

Corner Rpt: _____

DOUGLAS COUNTY
SURVEYOR

DOUGLAS COUNTY OFFICIAL RECORDS
BARBARA E. NIELSEN, COUNTY CLERK

2003-009580



\$26.00

00021156200300095800010017

04/09/2003 11:41:36 AM

PLAT-CORR Cnt=1 Stn=18 RECORDINGDESK
\$5.00 \$11.00 \$10.00

END OF DOCUMENT

C.S. File No 65/47-3