

MAP OF SURVEY

LOCATED in Section 34, T.31S., R.9W.,
W.M. in Douglas County, Oregon.

January 16, 2003

FILED

Date: 1/17/2003 By: JP

This survey consists of:

Map: C.S. 65/46-1

Narrative: _____

Corner Rpt: _____

DOUGLAS COUNTY
SURVEYOR

SURVEYED FOR: *SWANSON GROUP, INC.*
P.O. BOX 250
GLENDALE, OREGON 97442

SURVEYED BY: *DAVID EDWARDS LAND SURVEYING*
P.O. BOX 361
OAKLAND, OREGON 97462
PHONE: (541) 459-0512

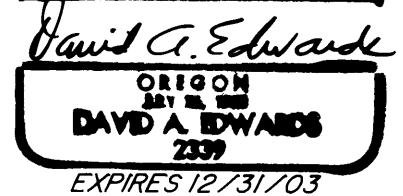
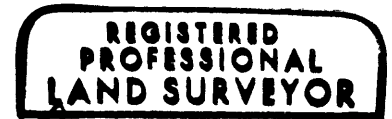

LEGEND

⊙ INDICATES BRASS CAP 1/4 CORNER FOUND.

————— DENOTES BOUNDARY POSTED AND BLAZED THIS SURVEY.

BASIS OF BEARINGS: G.L.O. PLAT BY PROTRACTION.

SCALE: 1" = 1000'

NARRATIVE

THE PURPOSE OF THIS SURVEY IS TO LOCATE, SET STEEL POSTS ON, BLAZE TREES ALONG AND FLAG THE EAST- WEST CENTERLINE OF SECTION 34. TREES WERE BLAZED ON BOTH SIDES OF LINE IF WITHIN 3 FEET. STEEL POSTS WERE SET ALONG LINE AT INTERVALS OF 300' OR LESS. ORANGE AND BLUE COMBINATION FLAGGING WAS HUNG LIBERALLY ALONG THE TRUE LINE.

FIELD CREW: BRANT MILLER AND ERIC SPRINKLE.

EQUIPMENT: NIKON TOTAL STATION.

COMPS. AND DRAFTING: DAVID EDWARDS.

