

PUBLIC LAND CORNER

INDEX NO. 100240

WEYERHAEUSER COMPANY  
WILLAMETTE REGION

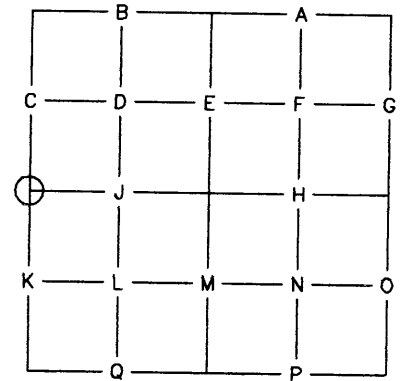

TOWNSHIP 23 SOUTH RANGE 3 WEST  
 SECTION 27 CORNER W 1/4  
 COUNTY LANE/DOUGLAS OREGON

ORIGINAL CORNER DATED: 1882 BY: GLO - CURRIN  
 CORNER: 5" HEMLOCK - MARKED 1/4 S ON WEST FACE  
 ACCESSORIES: 5" HEMLOCK, EAST, 18 LKS.  
6" FIR, WEST, 30 LKS.

RE-ESTABLISHMENT NOTES DATED: 1959 BY: M. D. HALE - C.S. 51/25 & C.S. 53/107  
 EVIDENCE RECOVERED: \_\_\_\_\_  
 CORNER SET: 1/2" IRON PIPE  
 ACCESSORIES ESTABLISHED: 30" HEMLOCK STUMP, S 16 W, 53.3 FEET TO "W" NAIL  
36" CEDAR STUMP, S 9 E, 132.0 FEET TO "W" NAIL

RE-ESTABLISHMENT NOTES DATED: \_\_\_\_\_ BY: \_\_\_\_\_  
 EVIDENCE RECOVERED: \_\_\_\_\_

CORNER SET: \_\_\_\_\_  
 ACCESSORIES ESTABLISHED: \_\_\_\_\_

REMONUMENTATION  
 DATE: 6/25/03 BY: DAVID WELLMAN TITLE: PLS 2163 FIRM: D. WELLMAN SURVEYING  
 EVIDENCE RECOVERED: 1/2" IRON PIPE - 1.0 FEET AGL  
1959 SW HEMLOCK STUMP BT DECAYED  
36" CEDAR STUMP, WEYCO TAG READS "N 9 W, 132.0 FEET" TO "W" NAIL IN FACE  
 CORNER SET: 1-3/4 X 36" IRON PIPE WITH BRASS CAP DATED 2003 - 0.7' AGL  
BRASS CAP SET OVER THE TOP OF 1/2 IRON PIPE  
 ACCESSORIES ESTABLISHED: \_\_\_\_\_  
14" FIR, N 84-1/2 E, 21.9 FEET TO SPIKE SET SIDE CENTER - SCRIBED "1/4 S27 BT"  
16" FIR, S 78 W, 4.9 FEET TO SPIKE SET SIDE CENTER - SCRIBED "1/4 S28 BT"  
17" FIR, N 17 E, 15.1 FEET TO SPIKE SET SIDE CENTER - SCRIBED "1/4 S27 BT"

OTHER INFORMATION: \_\_\_\_\_

SECTION 27 TOWNSHIP 23 S RANGE 3 W

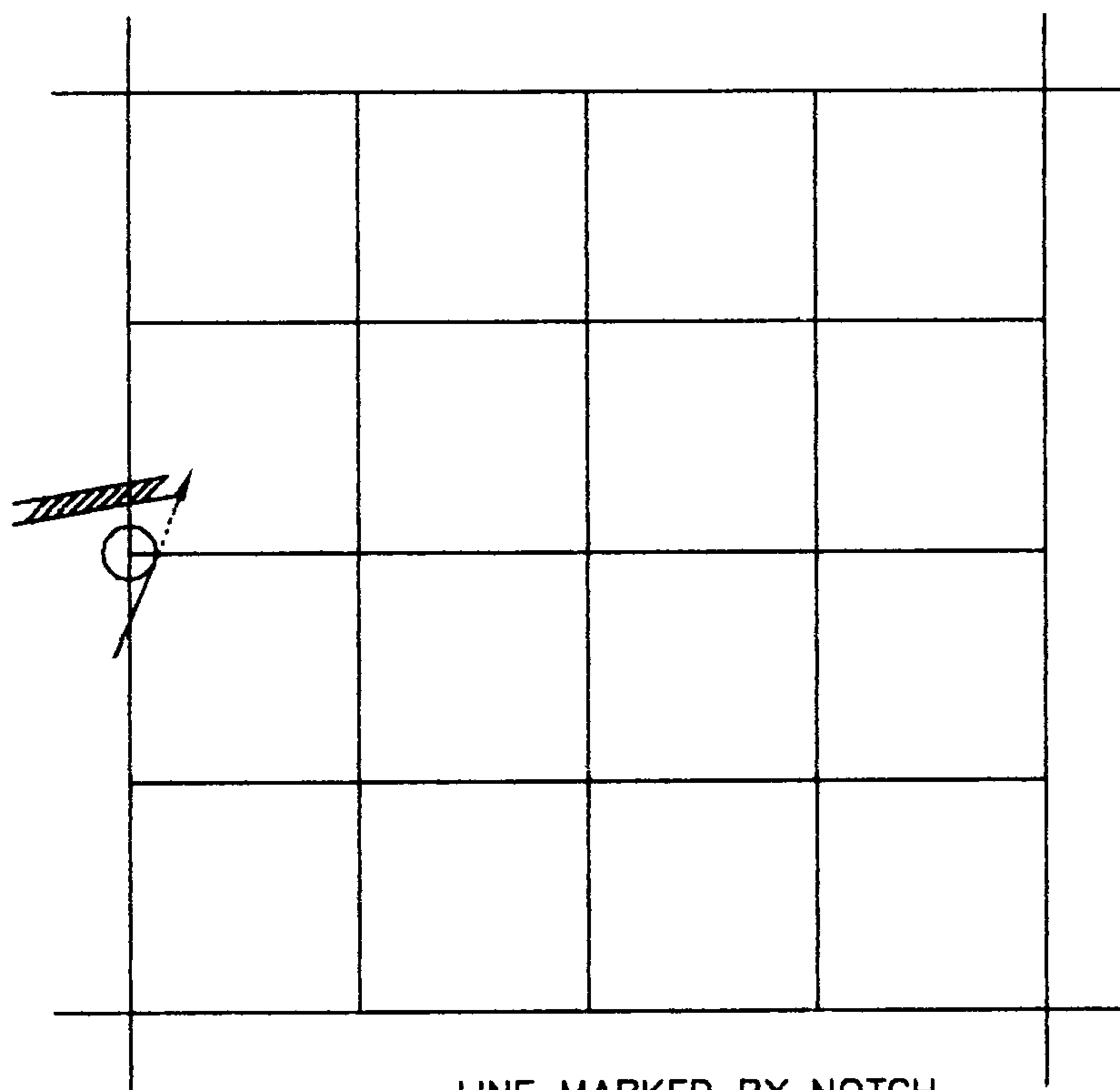

- LINE MARKED BY NOTCH CUT IN BLAZE
- KNOWN CORNER
- REFERENCED CORNER BY WEYERHAEUSER METHOD

SKETCH

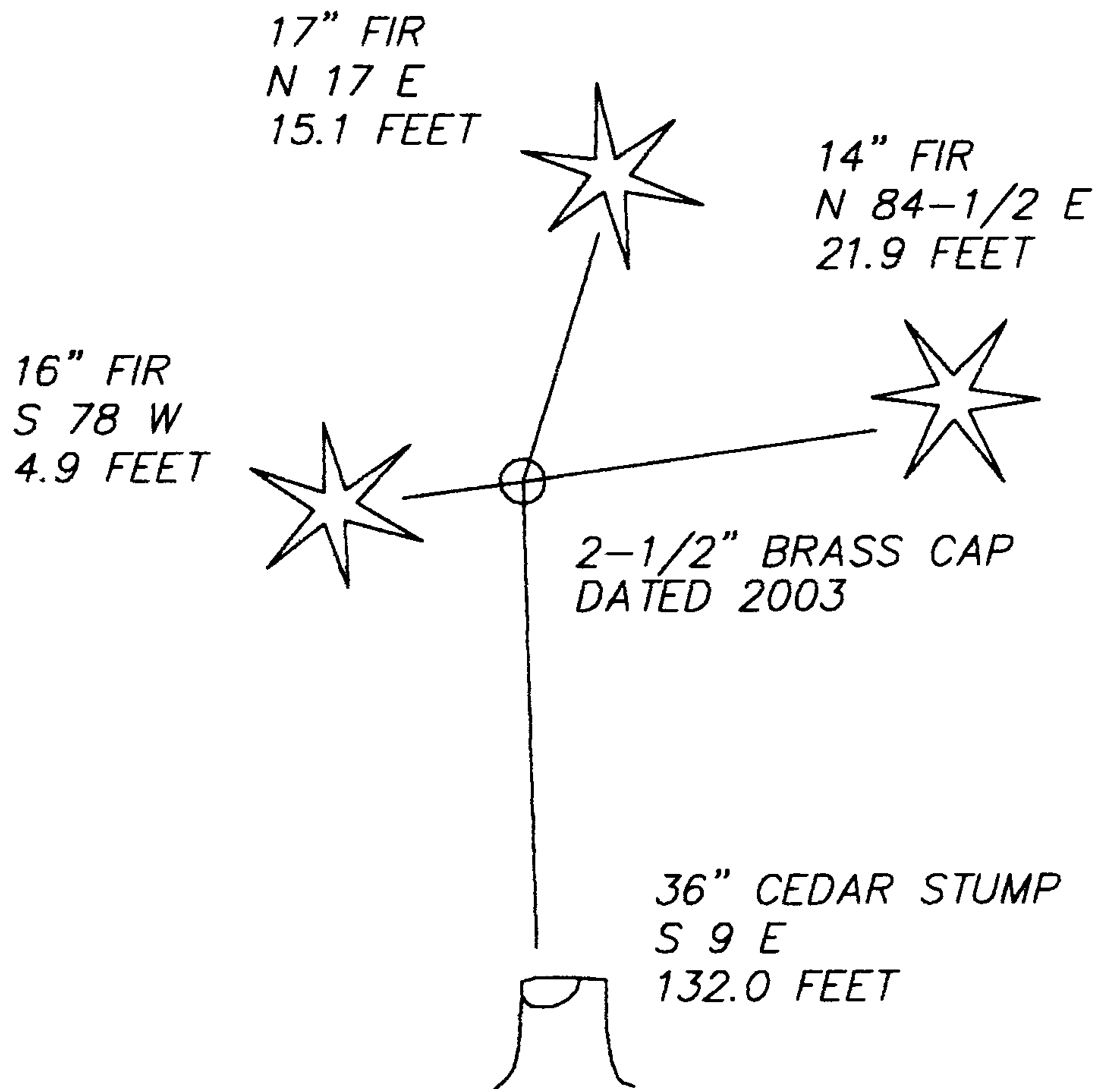

EAST, 60 FEET SMALL CREEK FLOWING N 20 E  
CORNER IS APPROX. 200 FEET SOUTH OF 2400 RD.

WEYERHAEUSER COMPANY

CORNER REFERENCE METHOD

A "W" NAIL DRIVEN INTO A NOTCH LOW ON A TREE OR STUMP. TWO BLAZES SCRIBED AS APPROPRIATE TO CORNER LOCATION. AN INSCRIBED BEARING TREE TAG PLACED HEAD HIGH WITH DISTANCE AND BEARING FROM THE "W" NAIL TO THE CORNER. PAINTED BAND ABOVE THE TAG.

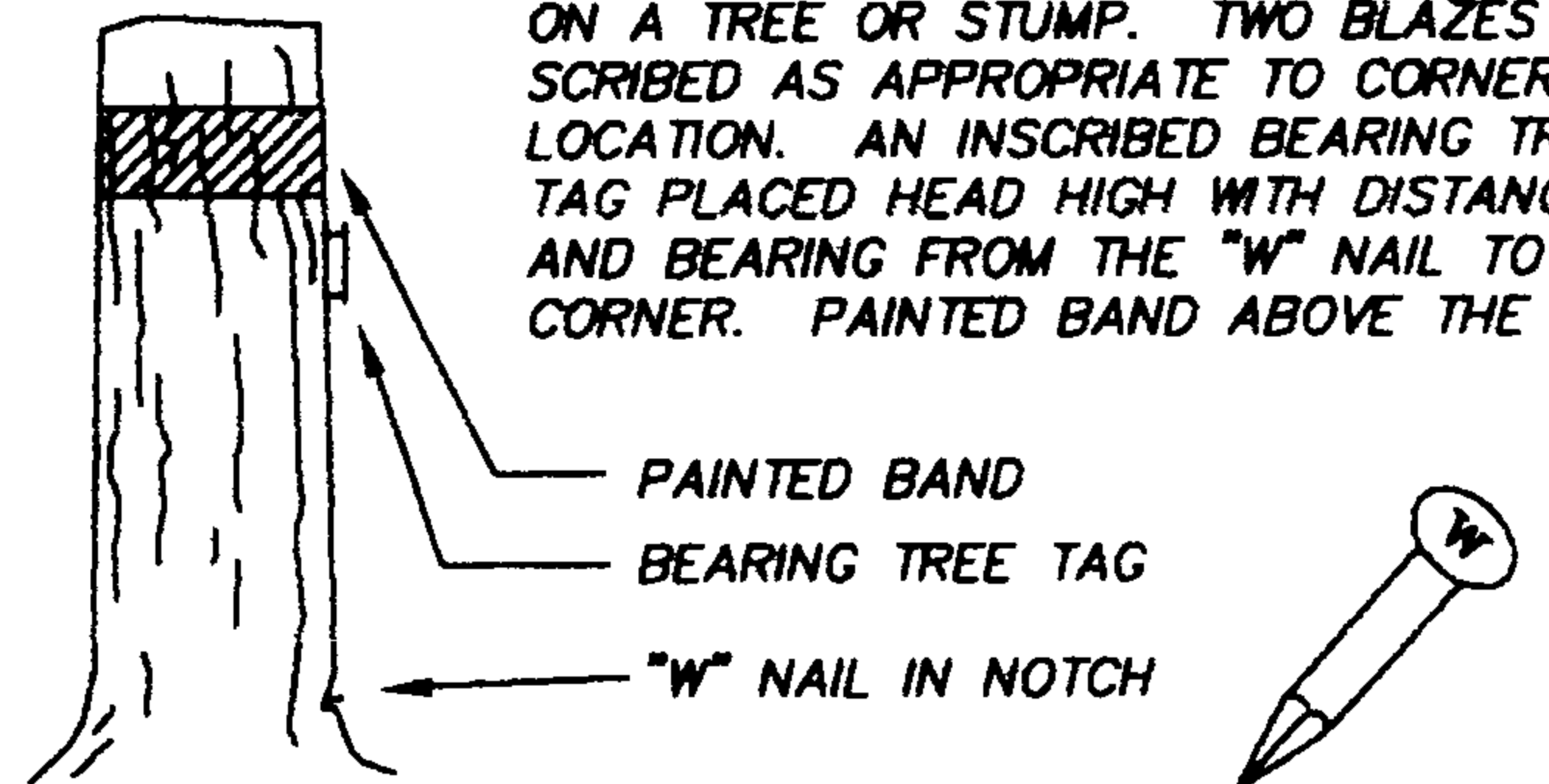

IDENTIFIED ON PHOTO: \_\_\_\_\_

INFORMATION ON CORNER AS NOW SET

GROUND COVER: FIR AND HEMLOCK TO 25", SWORD FERN

SLOPE FACE (BEARING) EAST (-) 50 %

FROM CORNER

NORTH	<u>+5%</u>
SOUTH	<u>-10%</u>
EAST	<u>-50%</u>
WEST	<u>+60%</u>

BY: DAVID WELLMAN DATE: 6/25/03

FIRM: D. WELLMAN SURVEYING

ASSISTED BY: ERIN HEATHERSTONE  
MICAH JOHNSTONE

COPIES TO: LANE AND DOUGLAS COUNTY

ORS 672-025

REGISTERED  
PROFESSIONAL  
LAND SURVEYOR

*David H. Wellman*

OREGON  
JULY, 1985  
DAVID H. WELLMAN  
2163

RENEWAL 6/30/04

C.S. File No 65/45-33B