

Date: 6/10/2003 By: JP

This survey consists of:

Map: M 142-36

Name: _____

Corner Rpt: CS 65/45-32 K

CORNER REPORT FORM

Section 4 Township 31S Range 4 W.W.M.

Douglas County Date May 25, 2003

CORNER DESIGNATION

400640

1/4 CORNER TO SECTION 4 AND SECTION 3

DOUGLAS COUNTY
SURVEYOR

x Condition Report only
Not Found
Renewed
Unrecorded
Surveyed In
Referenced out

Previous Renewals/Surveys, etc:

William Bushey #620, June 17, 1893 (DCSO Vol 18 Pg 7834).
Markham Jr. March 9, 1960 C.S. 42/391

Monument(s) & Accessories Found: (Condition and Source)

3/4" iron pipe 0.7 feet above grade.

Original bearing trees: (A fir snag 6" Bears N43E, 11.9 feet) Not Found.
(A cedar snag 26" Bears S32W, 29.7 feet) Found Down.

A fir 19" with healed face and tag Bears S58E (S54E), 24.0 feet.

A alder 13" Bears S83W, 3.9 (3.5) feet.

A fir 12" with healed face and tag Bears S18E, 21.3 feet.

Unrecorded bearing trees: A alder 9" with visible scribe, brass face washer "LS2354", tag and nail at side center
Bears N12W, 22.2 feet.

A douglas fir 10" with visible face scribe Bears N48E, 33.6 feet.

Monument Detail

Sketch

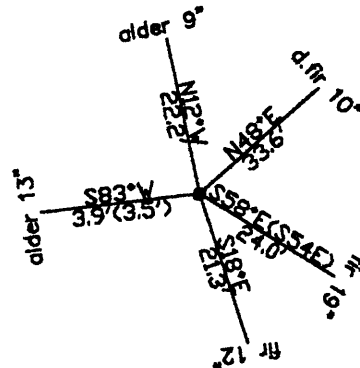

Monument Set (Procedures and Description)

New Accessories

Bearing trees were red band and face painted. Tags were added where needed.

Location & Comments

Corner falls on top of a small SE sloped ridge. Land to the west was recently clear-cut. Land to the east is still timbered.

Compass Declination 19 East

Firm/Agency: i.e. Engineering, Inc.

Address: 741 SE Jackson
Roseburg, OR 97470

Party Chief: Bruce Webster

Notes:

Witness:

Surveyor's Seal

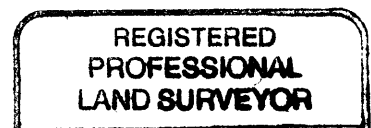

[Handwritten signature]

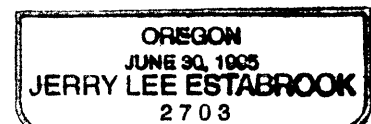

Exp. Date 12/31/03

C.S. File No 65/45-32K