

FILED

Date: 6/10/2003 By: JP

This survey consists of:

Map: M 142-36

Name: \_\_\_\_\_

Corner Rpt: CS 65/45-32 J

CORNER REPORT FORM

Section 4 Township 31 S Range 4 W.W.M.

Douglas County Date May 25, 2003

CORNER DESIGNATION

348700

(ANGLE POINT ON NORTH BDRY. SEC. 4)

DOUGLAS COUNTY  
SURVEYOR  
\* Condition \_\_\_\_\_  
Not Found \_\_\_\_\_  
Renewed \_\_\_\_\_  
Unrecorded \_\_\_\_\_  
Surveyed In \_\_\_\_\_  
Referenced out \_\_\_\_\_

Previous Renewals/Surveys, etc:

Nathaniel Ford - # 44 May 30, 1854 (DCSO Vol 16 Page 6985). Wm. Thiel # 535 February 5, 1889 (DCSO Vol 17 Page 7020).

Monument(s) & Accessories Found: (Condition and Source)

Looked for Not Found.

Monument Detail

Sketch

Monument Set (Procedures and Description)

New Accessories

Location & Comments

Compass Declination 19 East

Firm/Agency: i.e. Engineering, Inc.

Address: 741 SE Jackson  
Roseburg, OR 97470

Party Chief: Bruce Webster

Notes:

Witness:

Surveyor's Seal

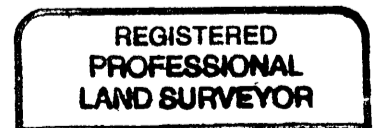

*Jerry Lee Estabrook*

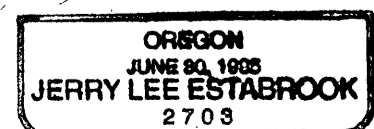

C.S. File No 65/45-32 J Exp. Date 12/31/03