

FILED

Date: 6/10/2003 By: JP

This survey consists of:

Map: M 142-36

Name: _____

Corner Rpt: CS 65/45-32 G

CORNER REPORT FORM

Section 4 Township 31S Range 4 W.W.M.

Douglas County Date May 25, 2003

CORNER DESIGNATION

W 1/16 NORTH LINE - SECTION 4 ONLY

DOUGLAS COUNTY

Condition Reported SURVEYOR

Not Found

Renewed

Unrecorded

* Surveyed In

Referenced out

Previous Renewals/Surveys, etc:

Monument(s) & Accessories Found: (Condition and Source)

Monument Detail

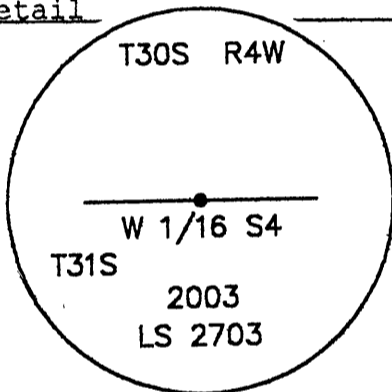

Sketch



Monument Set (Procedures and Description)

Set 2-1/2" aluminum cap on a 5/8" x 30" iron rod 29" deep.

Portioned in at mid point between northwest closing corner and north 1/4 corner (set this survey).

New Accessories

A douglas fir 8" Bears N32W, 12.9 feet face scribed "T30S R4W BT".

A douglas fir 9" Bears S27-30W, 8.1 feet face scribed "T31S R4W S4 W1/16 BT".

Distances are to spike set at side center. Trees were paint banded and face painted red. Tags were filled out and placed on bearing trees facing corner.

Location & Comments

Corner falls on 50% east slope 100 feet east of a old dirt ridge top haul road and 175 feet west of a rocked haul road.

Compass Declination 19 East

Firm/Agency: i.e. Engineering, Inc.

Address: 741 SE Jackson
Roseburg, OR 97470

Party Chief: Bruce Webster

Notes:

Witness:

Surveyor's Seal

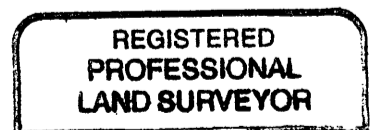

Jerry Lee Estabrook

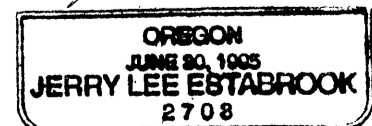

C.S. File No 65/45-32 G Exp. Date 12/31/03