

FILED

Date: 6/10/2003 By: JP

This survey consists of:

Map: M142-36

Narrative: _____

Corner Rpt: CS 65/45-32 D

CORNER REPORT FORM

Section 4 Township 31S Range 4 W.W.M.

Douglas County

Date May 25, 2003

CORNER DESIGNATION

302700

DOUGLAS COUNTY

- Condition **SURVEYOR** only
- Not Found
- Renewed
- Unrecorded
- Surveyed In
- Referenced out

Previous Renewals/Surveys, etc:

William Bushey #620, June 17, 1893.

Douglas County Surveyors Office June/July 1963 C.S. File 53/26.

BLM-resurvey Rogers, McMullen, Bishop September 1984/April 1986 (DCSO Vol 47 Page 18132).

Monument(s) & Accessories Found: (Condition and Source)

Brass cap on iron pipe 1.0 feet above grade next to Stone with notches.

A decayed fir stump 53" with healed face Bears N25-30E, 78.8 (76.6) feet.

A fir 45" with a healed face and tag Bears S33-45E, 35.6 feet.

A decayed shell of a fir stump size indeterminate with NO visible marks Bears N25W, 69.3 feet.

A madrone 10" with visible scribe and tag Bears N31-45E, 31.6 (32.3) feet.

A fir 20" with healed face Bears N33W, 31.0 feet.

Bearing trees were band painted and face painted red.

A tag was marked and placed on the 20" fir facing the corner.

Monument Detail

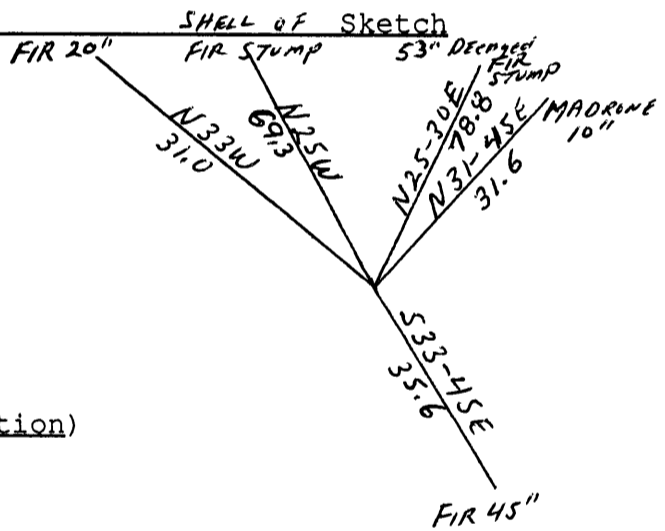
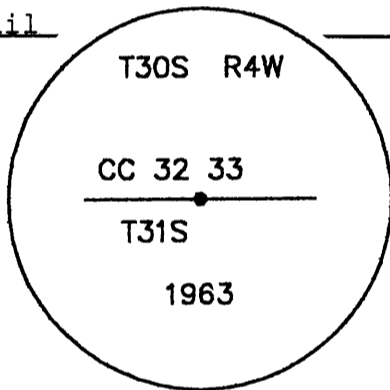

Monument Set (Procedures and Description)

New Accessories

Location & Comments

Corner Falls approximately 1050 feet west of a old dirt ridge top haul road on 70-80% west facing slope.

Compass Declination 19 East

Firm/Agency: i.e. Engineering, Inc.

Address: 741 SE Jackson
Roseburg, OR 97470

Party Chief: Bruce Webster

Notes:

Witness:

Surveyor's Seal

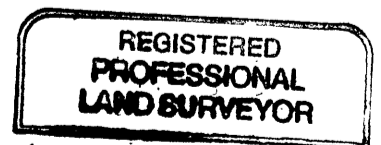

Exp. Date 12/31/03

C.S. File No 65/45-32 D