

FILED

Date: 5/8/2003 By: JC

This survey consists of:

Map: \_\_\_\_\_

Name: \_\_\_\_\_

Corner Rpt: 65/45-25

OREGON CORNER RESTORATION FORM

Section 24 Township 32S Range 8W

County Douglas Date 4/03

DOUGLAS COUNTY SURVEYOR

CORNER DESIGNATION

#700340

- Condition Report Only
- Not Found
- Renewed
- Unrecorded
- Surveyed In
- Referenced Out

Previous Renewals/Surveys, etc.

GLD - (DCSO RECORDS Vol. 20 PAGE 8708) AND C.S FILE 54/36

Monument(s) & Accessories Found: (Condition and Source)

- A 30" PINE (38") SNAG BEARS S70E, 46.2 FEET (TO FACE) (ORIGINAL)
- A 36" FIR STUMP (40") BEARS N85W, 28.4 FEET (TO FACE) (ORIGINAL)
- A 21" D. FIR (12") WITH HEALED FACE BEARS N24-30E, 27.7 FEET (CS 54/36)
- A 12" Y. PINE (6") WITH HEALED FACE BEARS S78W, 26.2 FEET (CS 54/36)

FOUND: 2 1/2" BRASS CAP ON 1" GALVANIZED IRON PIPE 0.8 ABOVE GRADE (CS 54/36)

Monument Detail

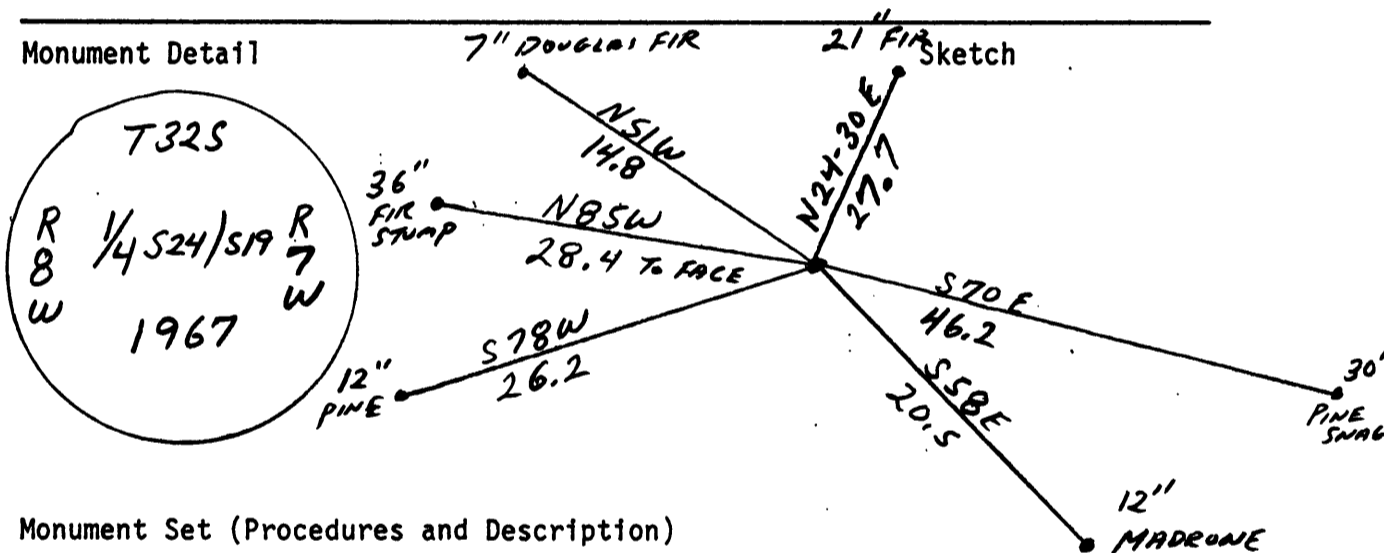

Monument Set (Procedures and Description)

New Accessories

- A 7" DOUGLAI FIR WITH X CHOP AT EYE HEIGHT AND A "BT" FACE SCRIBE AT BOTTOM FACE BEARS N 51 W 14.8 FEET TO SIDE CENTER.
- A 12" MADRONE SCRIBED "T32S R 7W S19 W 1/4 BT" BEARS S58E, 20.5 FEET TO SIDE CENTER.

Location & Comments

Surveyor's Seal

Compass Declination 17-30 E

Firm/Agency I.E.

ENGINEERING

Address 741 SE JACKSON

ROSEBURG, OR 97470

Party Chief BRUCE WEBSTER

Notes \_\_\_\_\_

Witness \_\_\_\_\_

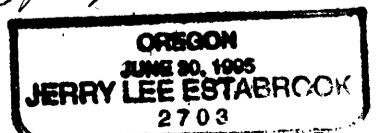
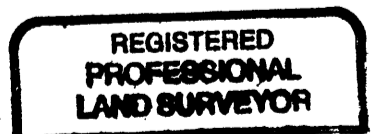

Exp. Date 12-31-03

C.S. File No 65/45-25