

FILED

Date: 5-8-2003 By: JC

This survey consists of:

Moss \_\_\_\_\_

Ne. \_\_\_\_\_

Corner 65/45-18

OREGON CORNER RESTORATION FORM

Section 20 Township 31S Range 7W

County DOUGLAS Date 4/03

DOUGLAS COUNTY  
SURVEYOR

CORNER DESIGNATION

#240300

- Condition Report Only
- Not Found
- Renewed
- Unrecorded
- Surveyed In
- Referenced Out

Previous Renewals/Surveys, etc. \_\_\_\_\_

(DCSO RECORDS Vol 19 PAGE 8074) 1882

(DCSO RECORDS Vol 33 PAGE 13643) 1964

Monument(s) & Accessories Found: (Condition and Source)

FD: BRASS CAP ON 2 1/2" IRON PIPE (B.L.M. 1963)

A 70" FIR STUMP BEARS S24W, 63.7 FEET (ORIGINAL)

A 30" FIR WITH HEALED FACE BEARS N2W, 44.6 FEET, (B.L.M. 1963)

A 11" FIR BEARS N68-30W, 26.7 FEET, (CS 65/44-14)

A 10" FIR BEARS N57E, 16.5 FEET, (CS 65/44-14)

A 13" W. FIR BEARS S8E, 74.0 FEET, (CS 65/44-14)

Monument Detail

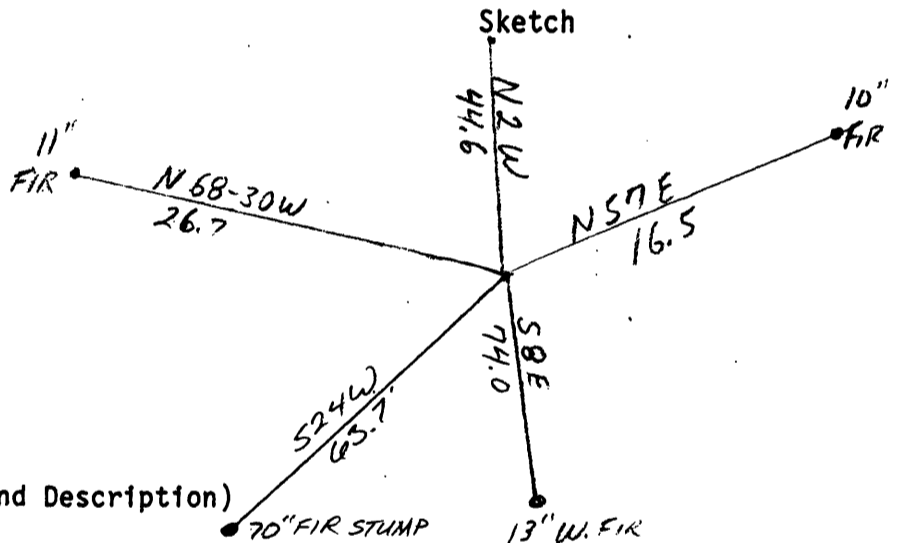
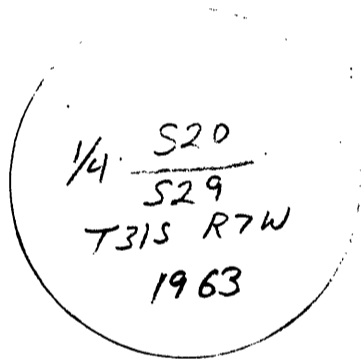

Monument Set (Procedures and Description)

New Accessories

Location & Comments

CREEK BEARS  
WEST 60' MORE  
OR LESS

Compass Declination 19 E

Firm/Agency I.E. ENGINEERING

Address 741 SE JACKSON  
ROSEBURG, OR 97470

Party Chief BRUCE WEBSTER

Notes \_\_\_\_\_

Witness \_\_\_\_\_

Surveyor's Seal

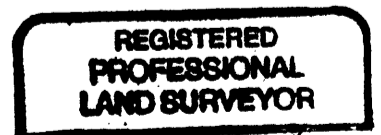

*Jerry Lee Estabrook*

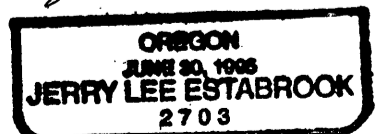

Exp. Date 12-31-03

C.S. File No 65/45-18