

PUBLIC LAND CORNER

INDEX NO. _____

WEYERHAEUSER COMPANY
WILLAMETTE REGION

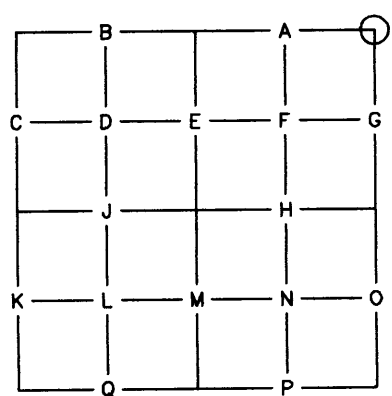

TOWNSHIP 22 SOUTH RANGE 4 WEST
 SECTION 10 CORNER NE CORNER
 COUNTY DOUGLAS OREGON

ORIGINAL CORNER DATED: 1884 BY: GLO - WRIGHT
 CORNER: POST AND STONE
 ACCESSORIES: 48" FIR, N 70 W, 8 LKS.
48" FIR, S 35 W, 7 LKS.
10" MAPLE, N 14 E, 41 LKS.
10" MAPLE, S 25 E, 47 LKS.

RE-ESTABLISHMENT NOTES DATED: 1962 BY: DOUGLAS COUNTY
 EVIDENCE RECOVERED: 24" MAPLE, S 25 E, 31.0 FEET
48" FIR, S 35 W, 6.6 FEET - DOWN AND OUT
48" FIR, N 70 W, 5.3 FEET
 CORNER SET: 1-1/4" IRON PIPE WITH DOUGLAS CO. BRASS CAP DATED 1962
 ACCESSORIES ESTABLISHED: 22" CEDAR, S 32 W, 6.0 FEET
27" FIR, N 8-1/2 E, 59.3 FEET
26" FIR, S 89 E, 60.6 FEET

RE-ESTABLISHMENT NOTES DATED: 1971 BY: DOUGLAS COUNTY
 EVIDENCE RECOVERED: 24" MAPLE, S 25 E, 31.0 FEET
22" CEDAR, S 32 W, 61.0 FEET
27" FIR STUMP, N 8-1/2 E, 59.3 FEET
 CORNER SET: RESET 1-1/4" IRON PIPE WITH 1962 DOUGLAS CO. BRASS CAP FROM EXISTING
BT'S, CORNER UPROOTED BY RECENT WINDFALL

RE-ESTABLISHMENT NOTES DATED: 1993 BY: BLM - BEDELL
 EVIDENCE RECOVERED: 1-1/4" IRON PIPE WITH DOUGLAS CO. BRASS CAP
32" MAPLE, S 25 E, 47 LKS., 34" CEDAR, S 30 W, 88 LKS. - CLOSED FACE
25" FIR STUMP, N 8-1/2 E, 90 LKS. - SCRIBING VISIBLE
 CORNER SET: _____
 ACCESSORIES ESTABLISHED: 12" FIR, N 82 E, 18.5 LKS.
4" FIR, N 6 W, 29 LKS. - BARK SCRIBED "X" BT

REMONUMENTATION

DATE: 3/10/03 BY: DAVID WELLMAN TITLE: PLS 2163 FIRM: D. WELLMAN SURVEYING
 EVIDENCE RECOVERED: 1-1/4" IRON PIPE WITH 1962 DOUGLAS CO. BRASS CAP, 1' AGL
26" MAPLE, S 22 E, 30.2 FEET TO SPIKE SET SIDE CENTER, 1954 BLM TAG READS
"N 25 W, 71 LKS." - ROTTEN FACE
34" CEDAR, S 34 W, 60.4 FEET TO SPIKE SET SIDE CENTER - CLOSED FACE
15" FIR, N 81 E, 8.7 FEET TO SPIKE SET SIDE CENTER - CLOSED FACE
4" FIR, N 14 W, 19.1 FEET TO SPIKE SET SIDE CENTER, 1993 BLM TAG READS
"S 6 E, 29.4 LKS." - "X" VISIBLE
24" FIR STUMP, 1962 BLM TAG READS "S 8-1/2 W, 59.3 FEET" - ROTTING

OTHER INFORMATION: FENCE POST 1.0' EAST

SECTION 10 TOWNSHIP 22 S RANGE 4 W

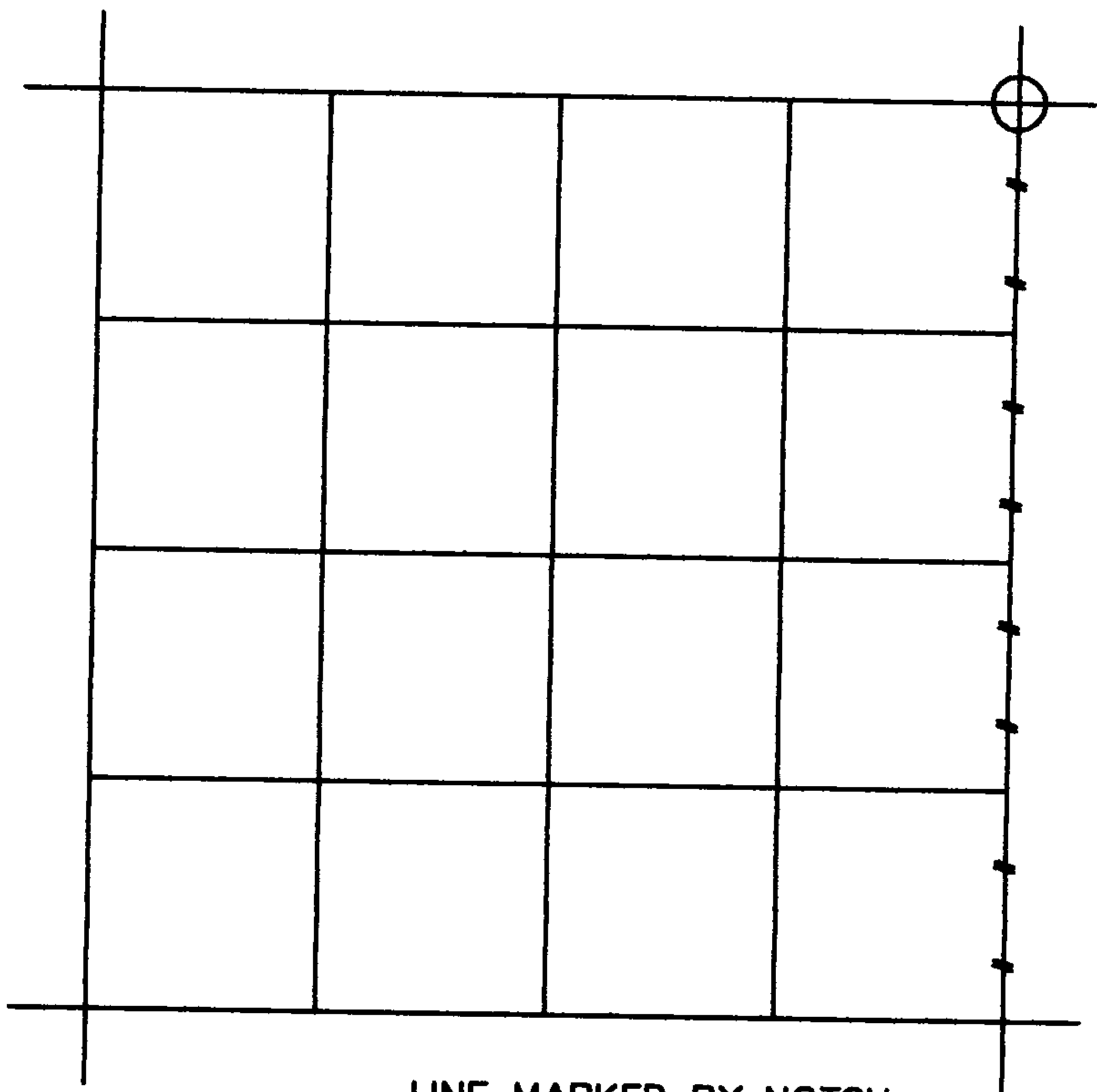

- LINE MARKED BY NOTCH CUT IN BLAZE
- KNOWN CORNER
- REFERENCED CORNER BY WEYERHAEUSER METHOD

SKETCH

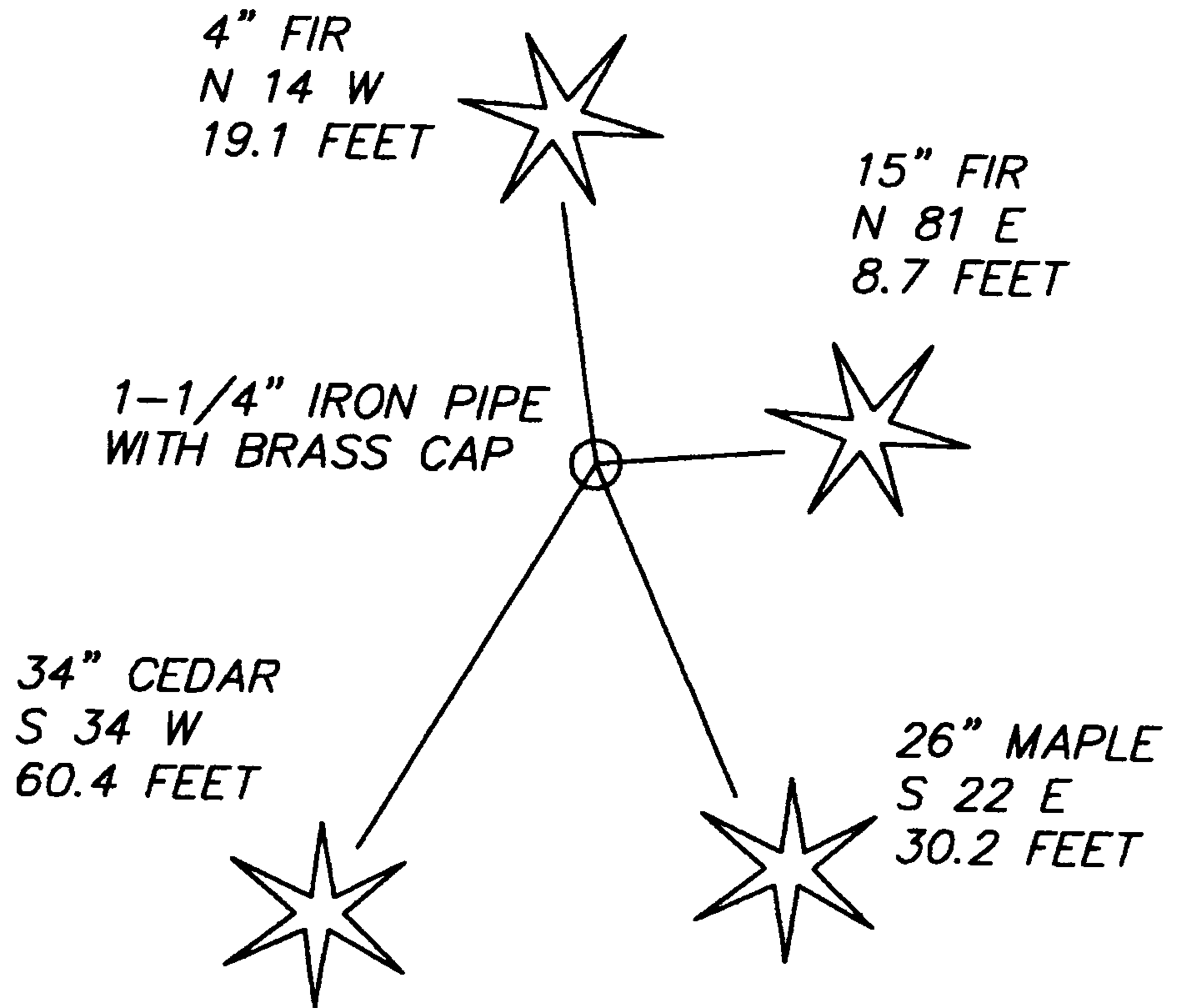

CREEK FLOWING N 82 W, 1' SOUTH OF CORNER

WEYERHAEUSER COMPANY
CORNER REFERENCE METHOD

A "W" NAIL DRIVEN INTO A NOTCH LOW ON A TREE OR STUMP. TWO BLAZES SCRIBED AS APPROPRIATE TO CORNER LOCATION. AN INSCRIBED BEARING TREE TAG PLACED HEAD HIGH WITH DISTANCE AND BEARING FROM THE "W" NAIL TO THE CORNER. PAINTED BAND ABOVE THE TAG.

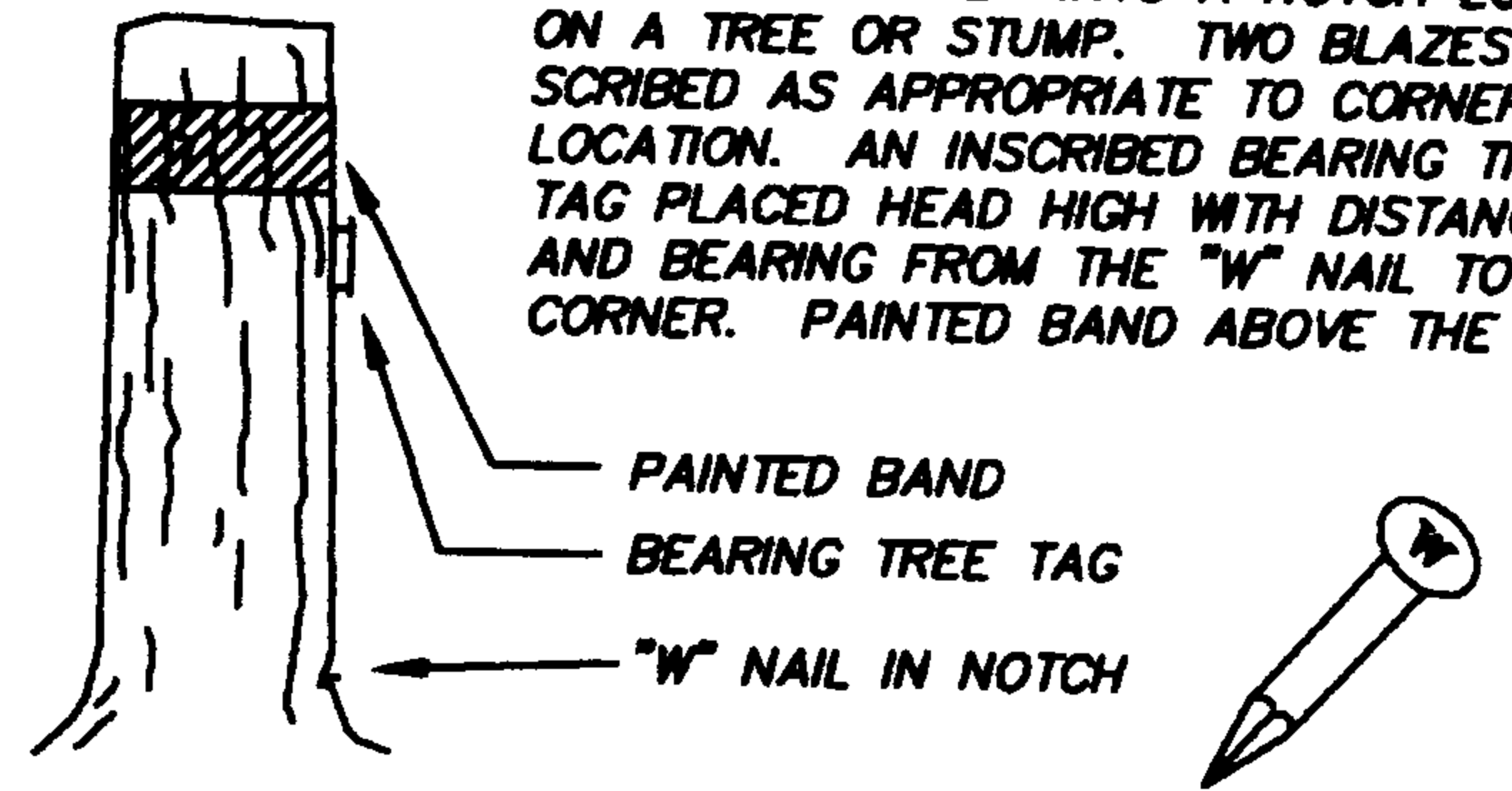

IDENTIFIED ON PHOTO: _____

INFORMATION ON CORNER AS NOW SET

GROUND COVER: FIR, MAPLE, HEMLOCK, CEDAR TO 35", SALAL, OREGON GRAPE, FERN

SLOPE FACE (BEARING) WEST (-) 65% %

FROM CORNER

NORTH +27%

SOUTH BROKEN GROUND FOR 20' THEN +38%

EAST +46%

WEST FLAT FOR 15' THEN -65%

BY: DAVID WELLMAN DATE: 3/10/03

FIRM: D. WELLMAN SURVEYING

ASSISTED BY: ERIN HEATHERSTONE

COPIES TO: DOUGLAS COUNTY

ORS 672-025

REGISTERED PROFESSIONAL LAND SURVEYOR

David H. Wellman

OREGON
JULY, 1985
DAVID H. WELLMAN
2163

RENEWAL 6/30/04

C.S. File No 65/45-10 B