

**REWITNESSED CORNER FOR  
STATE OF OREGON – DEPARTMENT OF FORESTRY**

Center one quarter corner common to Section 26, Township 23 South, Range 10  
West, W.M., Douglas County, Oregon.

**ESTABLISHED by Gregory K. Miller, 1984**

2 ½" galvanized iron pipe with 2 ½" brass cap (in place) from which a:

16" Cedar S62°E 17.8 ft.; now 17" x 4 ft. high stump in place, scribes visible,  
Champion Timberlands tag.

46" Fir N82°W 46.0 ft.; now 47" x 4 ft. high stump in place, scribes visible,  
Champion Timberlands tag.

**REWITNESSED from the above pipe and cap:**

Carsonite witness post N28°W 3.6 ft. to base.

Carsonite witness post N81°E 2.2 ft. to base.

Carsonite witness post S14°E 2.5 ft. to base.

Carsonite witness post S75°W 4.5 ft. to base.

Magnetic variation set at 20° east.

Dated January 21, 2003

Rewitnessed by Jim VanVleet under my direction.  
Tim VanVleet

Oregon Dept. Of Forestry  
63612 Fifth Rd.  
Coos Bay, OR 97420

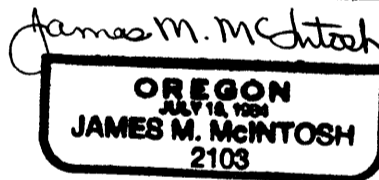
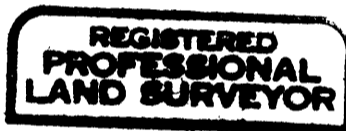

Expiration date of certificate 12-31-04

Present and witnessed by Ralph C. Hall.

**FILED**  
Date: 3-11-2008 By: Jc  
This survey consists of:  
Map: \_\_\_\_\_  
Name: \_\_\_\_\_  
Corner Rpt: 65/45-8

DOUGLAS COUNTY  
SURVEYOR

C.S. File No 65/45-8