

FILED

Date: 6/21/2002 By: JP

This survey consists of:

Map: M137-44

Narrative: _____

Corner Rpt: CS 65/44-6J

OREGON CORNER RESTORATION FORM

Section 14 Township 30S Range 6W

County Douglas Date April, 2002

DOUGLAS COUNTY
SURVEYOR

Corner Designation

526 | 525
535 | 536

- Condition Report Only
- Not Found
- Renewed
- Unrecorded
- Surveyed In
- Referenced Out

Previous Renewals/Surveys, etc.

J.H. Markham, C.S. File 40/188, in 1949.

Douglas County Surveyor James Byron, C.S. File 52/25 in 1960.

Monument(s) & Accessories Found: (Condition and Source)

Found 1" Iron Pipe with 2 1/2" Brass Cap, from which a:
10" Madrone BT, scribes visible, bears S70°W, 90 feet.
38" Black Oak BT, face overgrown, bears S42°E, 581 feet.
9" W. Oak BT bearing N52°W, 575 feet is now gone.
18" White Oak BT stump bears N3°E, 405 feet.

N-S fence is East, 20 feet from corner.

3" x 96" Alum. Pipe is alongside corner.

Monument Detail

Sketch

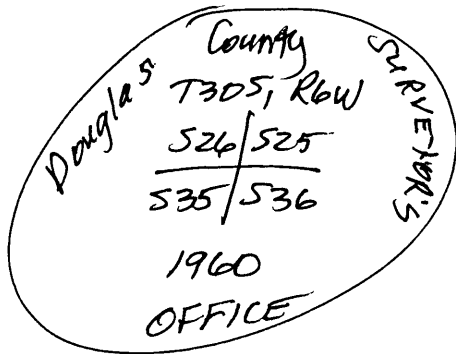

Monument Set (Procedures and Description)

N/A

New Accessories

12" Madrone BT, I bark scribed "T30S, R6W, S25, BT"
bears N14°E, 71 feet.

8" Madrone BT, I bark scribed "T30S, R6W, S26, BT"
bears N15°W, 165 feet.

Location & Comments

Corner lies on
ridge top at 25
feet west of
dirt road running
N-S.

Compass Declination 20°E

Firm/Agency Shaner

Engineering, Inc.

Address P.O. Box 1430

Roseburg, OR 97470

Party Chief B. Shaner

Notes " "

Witness Ben Schneider

Surveyor's Seal

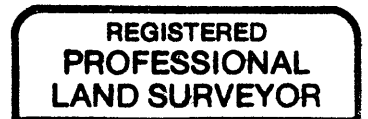

Bruce A. Shaner

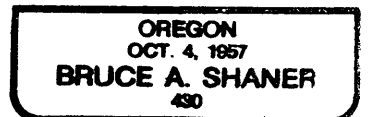

C.S. File No 65/44-6J Renews June 30, 2002