

FILED

Date: 6/21/2002 By: JP
This survey consists of:
Map: M 137-44
Narrative: _____
Corner Rpt: CS 65/44-6C

OREGON CORNER RESTORATION FORM

Section 14 Township 30S Range 6W

County Douglas Date June 19, 2002

DOUGLAS COUNTY
SURVEYOR

Corner Designation

510 | 511
515 | 514

- Condition Report Only
- Not Found
- Renewed
- Unrecorded
- Surveyed In
- Referenced Out

Previous Renewals/Surveys, etc.

Douglas County Surveyor, 1964
Robert Mason, M 87-10 & C.S. Files 58/255 & 61/15

Monument(s) & Accessories Found: (Condition and Source)

Found 2 1/2" Brass Cap on a 1" Iron Pipe, from which a:

11" Madrone BT bears N56°E, 29.0 feet.

10" " " " 529°W, 54.5 feet.

14" " " " N9°E, 49.2 feet.

14" " " " S9°E, 52.0 feet.

16" D. Fir BT, Face overgrown, bears N75°W, 33.0 feet.

Monument Detail

Sketch

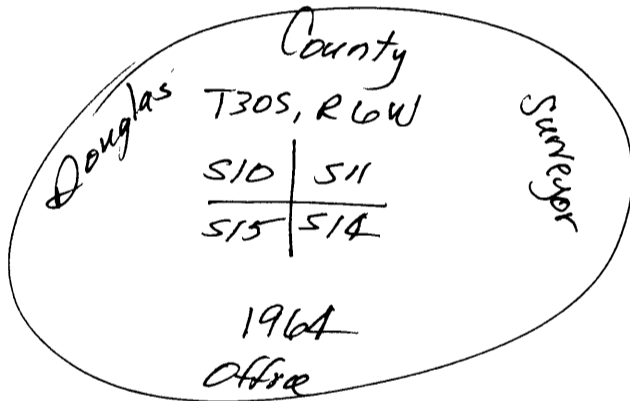

Monument Set (Procedures and Description)

None

New Accessories

None

Location & Comments

Surveyor's Seal

Corner sets on Compass Declination 20°E
East-West Fence Firm/Agency Shaner
Line (a newer fence) Engineering, Inc.
 Address P.O. Box 1430
Roseburg, OR 97470
 Party Chief B. Shaner
 Notes _____
 Witness G. Panskyne

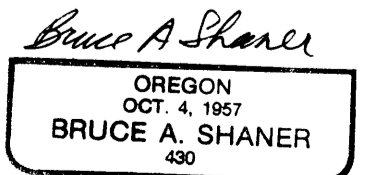
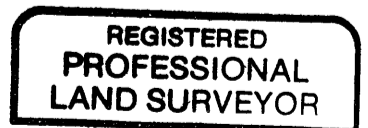

C.S. File No 65/44-6C Renews June 30, '04