

FILED

Date: 12-2-2002 By: JC

This survey consists of:

Map: _____

Narrative: _____

Corner Rpt: 65/44-27

OREGON CORNER RESTORATION FORM

Section: 24 Township: 20S Range: 12W

County: Douglas Date: 11/22/02

DOUGLAS COUNTY
SURVEYOR

Corner Designation

Corner to Sections 24 & 25

- Condition Report Only
- Not Found
- Renewed
- Unrecorded
- Surveyed In
- Referenced Out

Previous Renewals/Surveys, etc.:

GLO survey by Harvey Gordon in 1857, GLO survey in 1891 by William Thiel, a 1963 survey by Warren Hootman (M 22-36), a 1992 Douglas County surveyors office renewal (CS 64/26), and a 1998 survey by Troy Rambo (M 131-9).

Monument(s) & Accessories Found: (Condition and Source)

- Fd. 1" iron pipe with 3" brass cap marked "T20 S24 S25 S19 R12 R11 399" set over 1/2" iron pipe.
- 74" rotten spruce stump, S38°E 38.7 Ft.
- 32" cedar, S20°E 15.1 Ft. to side center, healed face.
- 24" hemlock, S51°W 42.6 Ft. to side center, visible scribe (record 43.5 Ft.).
- 15" cedar, now N44°W 2.2 Ft. to side center, leaning from logging (record N46°W 2.8 Ft.), visible scribe.

Monument Detail:

Sketch:

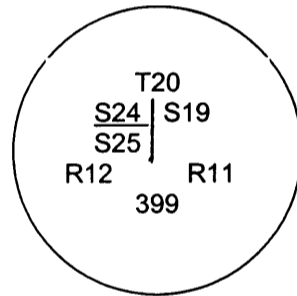

Monument Set (Procedures and Description):

Referenced monument with a Nikon DTM 530 Total Station and removed for logging operation. Reset above 1" iron pipe with 3" brass cap marked "T20 S24 S25 S19 R12 R11 399" with the above accessories remaining.

New Accessories:

Location and Comments:

The rotten spruce stump bearing N15°E 25.1 Ft. was destroyed by a spur road. The corner fall just south of this spur road.

Compass Declination: 18°E
Firm/Agency: Menasha
Forest Products Corporation
Address: _____
PO Box 588
North Bend, OR 97459
Party Chief: Brent Bacon
Notes: Brent Bacon

Witness: Doyce Rose

Surveyor's Seal

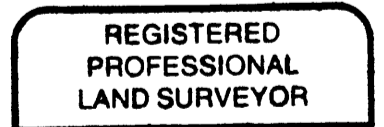

Brent W. Bacon

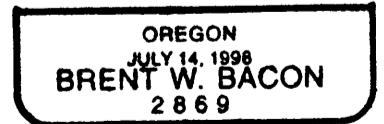

12-31-2003